



Please do not print me!

Remember to print from page 2 to avoid wasting paper and ink.
If you do find me, then visit [twinkl.co.uk](https://www.twinkl.co.uk) to find out why **millions of educators** worldwide love twinkl.

A brief word about copyright...

By downloading this resource, you agree to the following:



You may use this resource for personal and/or classroom use only.

In order to support us, we ask that you always acknowledge www.twinkl.co.uk as the source of the resource. **If you love these resources, why not let others know about Twinkl?**



You must not reproduce or share this resource with others in any form. They are more than welcome to download the resource directly from us.

You must not host or in any other way share our resources directly with others, without our prior written permission.

We also ask that this product is not used for commercial purposes and also that you do not alter the digital versions of our products in any way.

Thank you for downloading!

Twinkl Educational Publishing. Your first choice for easy to use, trusted and high quality teaching materials for educators and parents worldwide - professionally crafted materials with a personal touch.

[twinkl.co.uk](https://www.twinkl.co.uk)

Egg Box Daffodil

Supplies

- One segment of an egg box
- PVA glue
- Scissors
- Yellow or orange paint
- Paintbrush
- Green and yellow card
- Flower head template

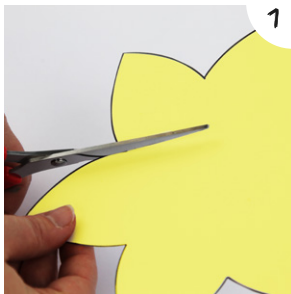

1 Draw around the flower head template onto yellow card, then cut out.



2 Paint the segment of egg box yellow or orange, then leave to dry.

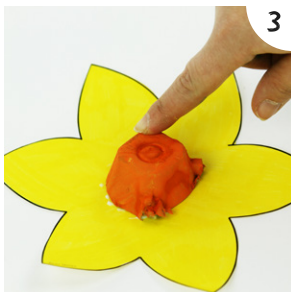

3 Stick the egg segment to the middle of the flower using PVA glue. Then add a strip of green card to create a stem.



4 Once dry, the daffodil can be hung or displayed on a wall.



Craft Instructions

Egg Box Daffodil



Supplies

- One segment of an egg box
- Flower head template
- PVA glue
- Scissors
- Yellow or orange paint
- Paintbrush
- Green and yellow card



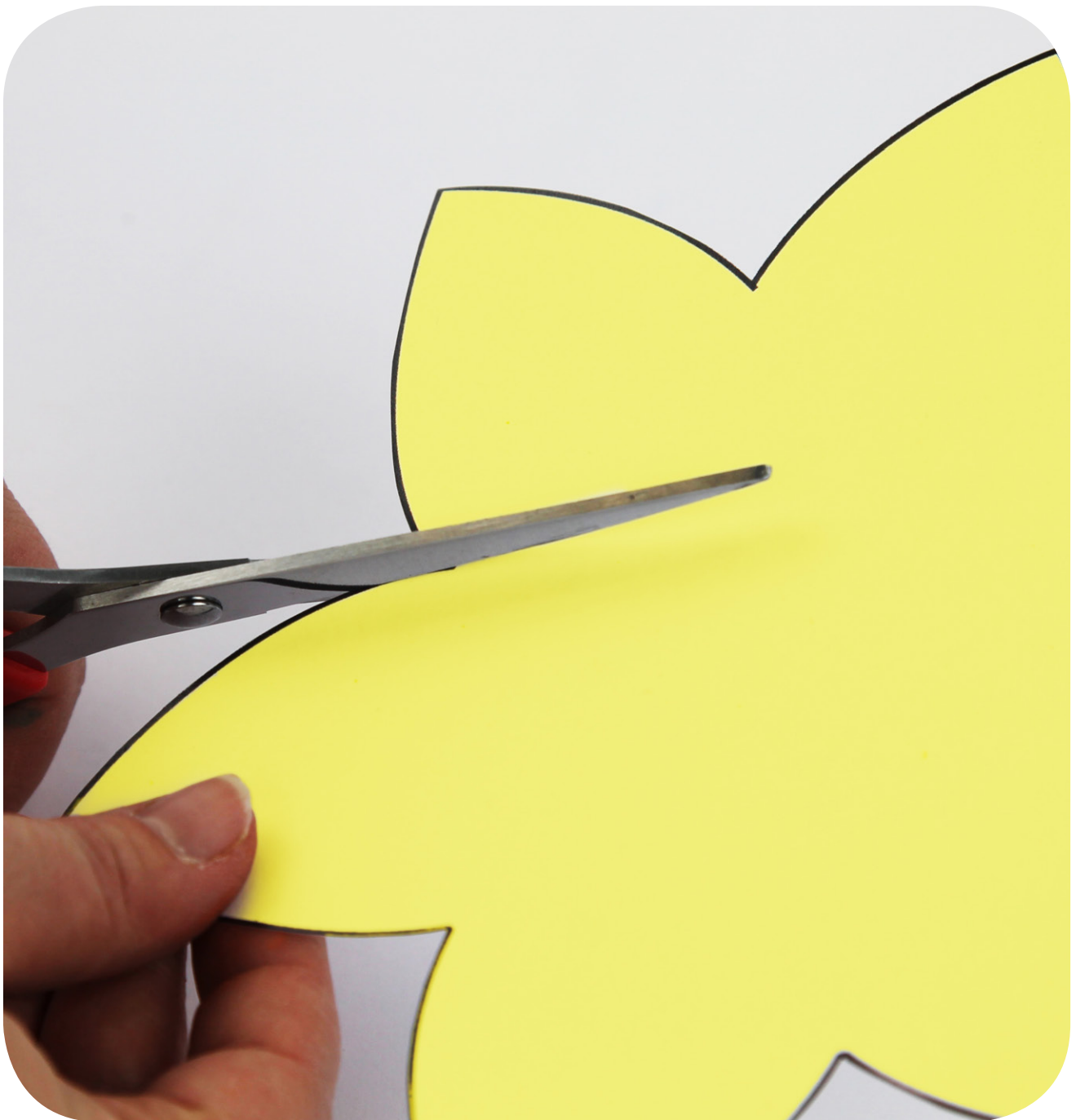

Step 1. Draw around the flower head template onto yellow card, then cut out.



Step 2. Paint the segment of egg box yellow or orange, then leave to dry.



Step 3. Stick the egg segment to the middle of the flower using PVA glue. Then add a strip of green card to create a stem.