



Shetland Islands Council
Children's Services



Head Teacher:
Mrs A-M Angus
Sound Primary School
Lerwick
Shetland
ZE1 0LY

01595 744982
sound@shetland.gov.uk

<https://blogs.glowscotland.org.uk/sh/soundschool/>

Working together to improve outcomes for learners to be the best that they can be.

29 June 2023

Dear Parents and Carers,

The end of the school year is fast approaching so I wanted to get in touch to share some information about the end of term as well as the new school session. Please take the time to read this letter as there will be changes in the new session.

School finishes for the Summer Holidays on Friday 30 June at 3pm. This year pupils in P1-6 will take home their work from across the year with the exception of their most recent Literacy, Numeracy and Project work as this will go with them into their next class. Keeping this work in school will support your child in their next steps when they return after the summer by providing evidence of their prior learning. Some of their jotters will continue to be used in the new school session, helping the school to resource more responsibly.

Pupils return to school on Wednesday 16 August 2023. The school day is from 9.00am to 3.00pm for pupils in P1-7 and pupils will attend Nursery as per their individual arrangements. Monday 14 and Tuesday 15 August are In-service days and the school is only open to staff.

Term Dates Session 2023/24

Please follow the link below to view school term dates on our blog:

<https://blogs.glowscotland.org.uk/sh/soundschool/for-parents/term-holiday-dates/>

What to Bring to School

- School Bag
- Water Bottle (no glass bottles)
- Pencil case for own use (stationery will be available at school)
- Snack - no nuts, **Sound Primary School is a nut free school**
- Labelling personal belongings with your child's name is advisable
- We kindly request that pupils do not bring toys or play equipment to school.

Art - It is not essential to provide an art apron for your child however if you want to, please make sure that it is clearly labelled. Any art aprons will be stored in school. Art lessons take place in the art hut.

P.E. – Pupils should come to school dressed in suitable clothing for taking part in P.E. e.g. trainers, joggers or leggings, a t-shirt and a sweatshirt or jumper. Pupils do not require a separate P.E. kit. P.E takes place indoors and outdoors.

Swimming lessons commence in Term 1 and take place in blocks of 5 or 6 weeks. Your child will need a swimming costume, towel and bag. You may also wish to provide goggles. Information about swimming will be shared at the start of the new term.

Outdoor Learning – please make sure that your child is dressed appropriately for the weather so that they are able to participate in class Outdoor Learning opportunities.

Entrances and Exits to School

The school politely requests that pupils arrive at school as close to 9.00am as possible, please note that indirect supervision will be available from 8.50am in the middle wing playground.

From August 2023 the school will return to using the following entrances at the start and end of the school day:

P1/2 pupils – infant wing entrance
P3/4 pupils- middle wing entrance
P5/6/7 pupils – senior wing entrance

The map below will help you locate the middle wing playground and the various entrances.

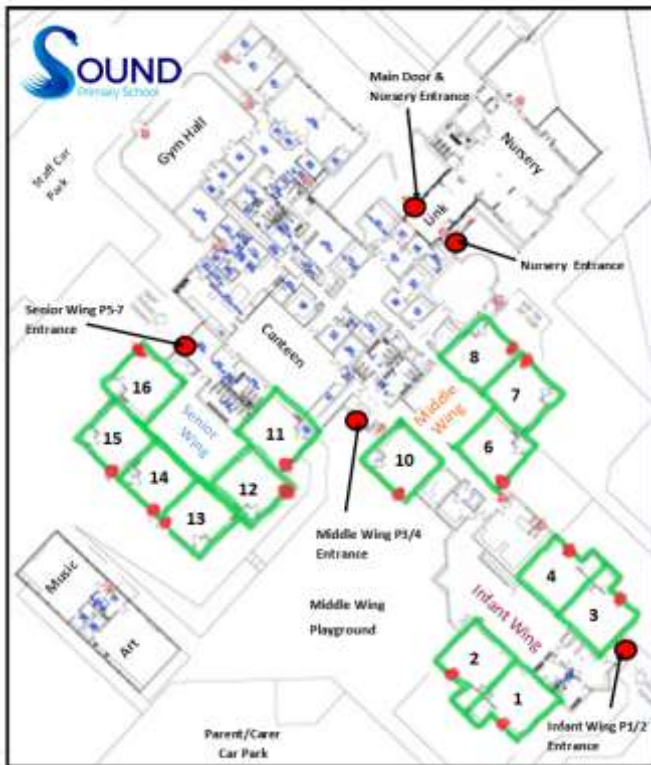

Nursery parents/carers and children should drop off and pick up using the Nursery door accessed via the school's main entrance door.

Parents/carers and visitors should use the main door of the school. Parents/carers should contact the school office should they need to take their child out of school during the school day.

Financial Assistance for Parents/Carers

Depending on your income, you may qualify for financial support in the form of Free School Milk and Meals or Clothing Grants. If you would like further information about this, please view the Shetland Islands Council website by following this link; [EMA, Bursaries and Financial Support – Shetland Islands Council](#)

Getting to School

Walking to school is encouraged. Should your child scoot or bike to school they should park their bikes/scooters in the area directly outside the main school entrance.

Shetland Islands Council Transport Department will contact parents/carers before the start of next session regarding the allocation of seats on school transport to and from Gulberwick.

School Logo clothing

School logo jumpers and other items of clothing are available to buy from Intersport. Please find attached an Intersport order form – orders are placed directly with the shop.

Home Learning

Thanks to those of you who completed our recent parent/carer Home Learning Questionnaire, your feedback has helped us to shape our approach to Home Learning for next school session. Please see a summary of key responses from parents/carers.

4. What do you think should be the home learning priorities?

Reading	71
Spelling	56
Maths	60
Health and Wellbeing	25
Other	7



9. What home learning resources work well for your family?

Reading book	70
Number notion pack	17
Online games	30
Paper resources/jotters kept a...	61
Other	14



12. Do you feel that school's approach to home learning could be improved?

Yes	57
No	24



Pupils have also provided feedback on Home Learning during a recent assembly. Almost all of our pupils shared that they enjoyed online learning games/activities and would like to continue to access these along with reading at home.

From Term 1 of next session, Primary 1 to 7 Home Learning will consist of reading or phonics. We will continue to share links to online resources that can support Literacy and Numeracy at home. There may well be times throughout the year where other types of home learning take place. Early next session, the school will update its handbook to reflect these changes. Your child's teacher will share more about Home Learning with you. The school will review our new approach to home learning with staff, parents/carers and pupils next session.

Thank You

Finally, myself, Mrs Gail McCulloch (DHT P4-7) and Mrs Jen Williamson (DHT Nursery-P3) along with all school staff look forward to welcoming you and your child/children to Sound Primary School and Nursery at the start of session 2023/24.

I would like to take this opportunity to wish you all a happy, safe and enjoyable summer holidays and thank you for your support over the last school year.

Kind Regards,

Mrs Ann-Marie Angus
Head Teacher