



*Welcome to the  
Anderson High  
School*

# Introduction

This PowerPoint contains photos of different parts of the school building.

Take your time and look through the photos.

It will help you begin to recognise different places in the school

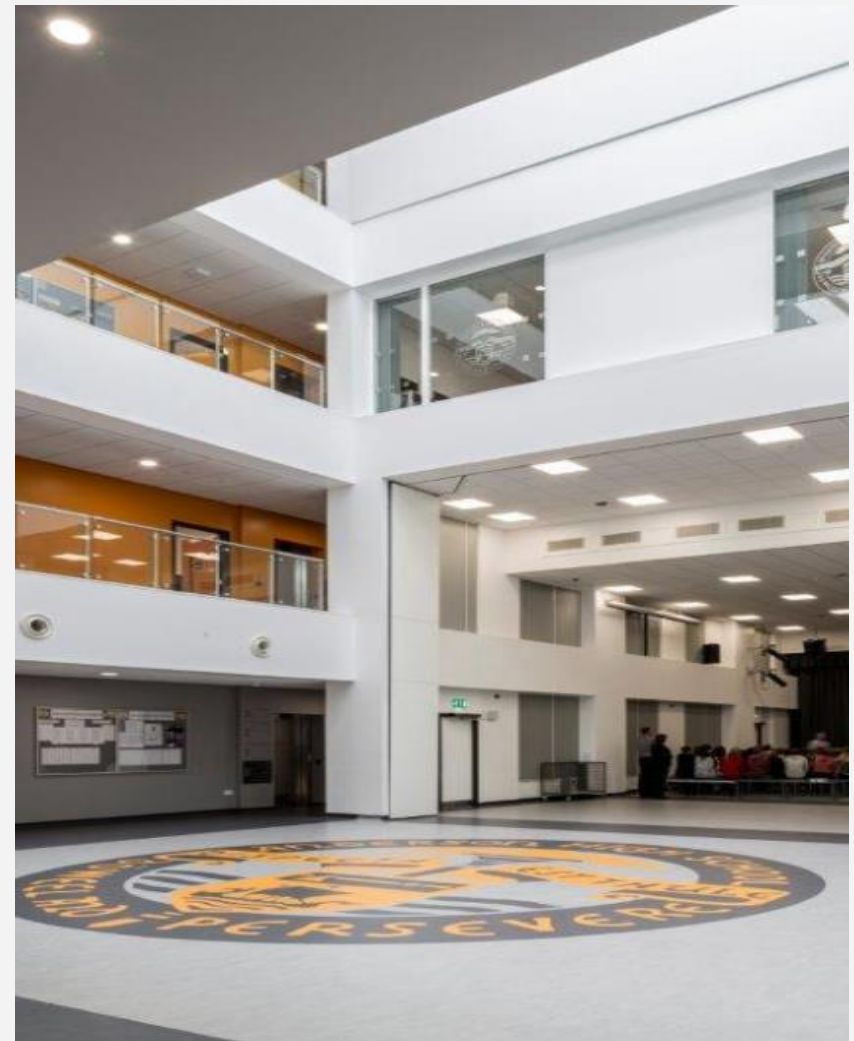
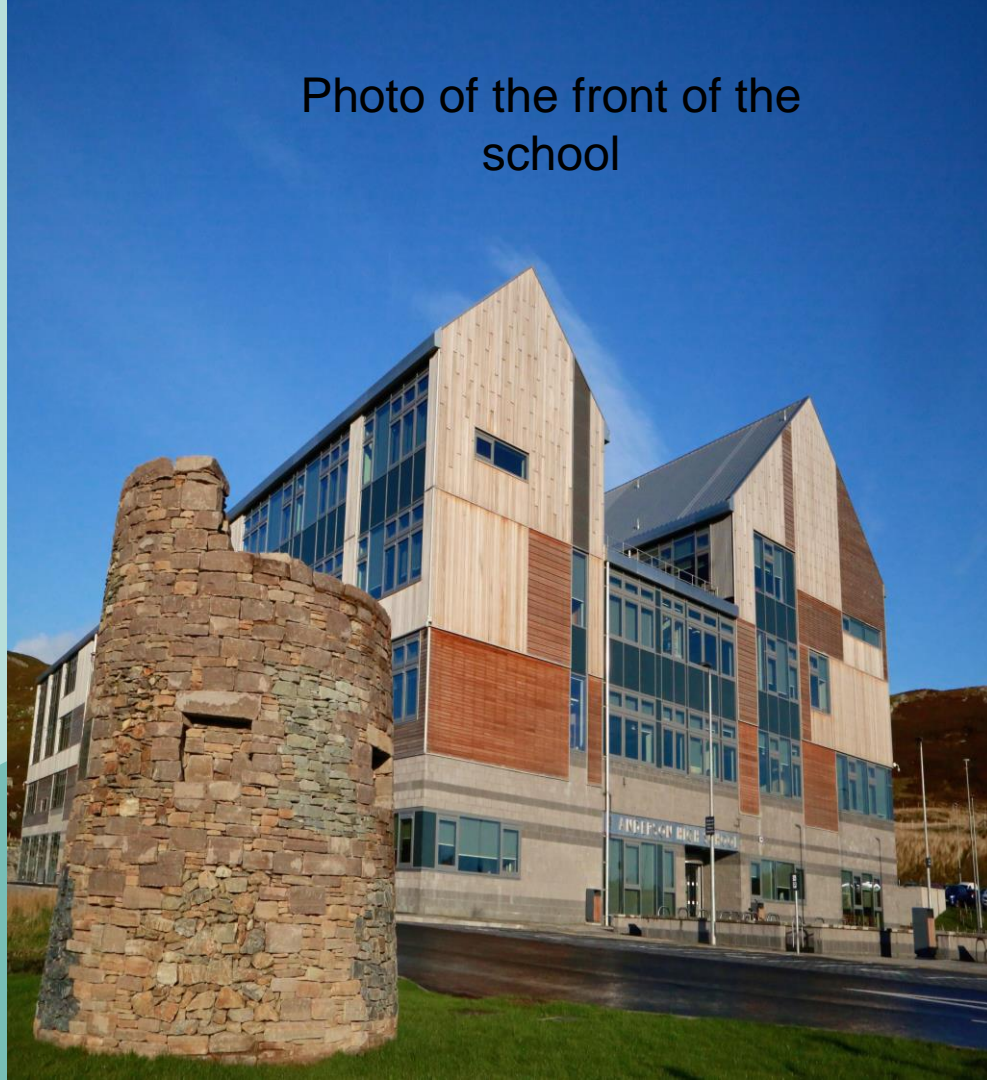



Photo of the front of the school



The main entrance is at the front of the school.

All pupils use this door to enter and exit the building.





The first thing you see when you come in the main entrance is the school hall.

The school hall is where S1 pupils sit at break and lunchtime.

When you come to school in the morning the school hall is where you will go until the bell rings for the start of your first class.



To your left when you come in the main entrance is the school office.

The Head Teacher, Ms Nicolson, has an office on the ground floor.

You can find your pupil support teacher in Room 0.07 which is on the ground floor near the school hall.

On the **Ground Floor** you can find:

- School office
- Head Teacher's Office
- Two Depute Head Offices
- Pupil Support Room 007
- School Hall
- Support for Learning Classrooms
- Youth Worker's office
- CDT practical workshops
- Lower Dining



## Lower Dining-

You can buy sandwiches, juice, water, salad and pasta boxes and soup here





In Upper Dining you will be able to buy sandwiches, fruit boxes, croissants, crisps and every fortnight on a Friday there will be bacon or sausage rolls!

You pay for your food at a till just as you would in a café.

S1 are released for an early lunch at 12.20.



In every stairwell there is a sign explaining what subjects are on the different floors.

The section that is highlighted in black shows you the floor that you are on.

Here we are on third floor.



If you are trying to find the stairs to the different floors look for the green exit sign.

These signs are above every set of doors that lead to the stairs.





In Home Economics you will always have a double period so that you have plenty of time to cook

## On First Floor, we have:

- Upper Dining
- Home Economics
- CDT Teaching classrooms
- Computing
- Business Studies
- Music
- Mrs Scollay's Office-  
Depute Head for S1 and S2
- ICT suite





The school library is on the Second Floor, right in the centre of the school.

The library is open before school and at break and lunchtime for all pupils if they wish to go.

Tanya and Lynn, our school librarians, run a range of activities in the library at lunchtime.



On the **Second Floor** we have:

- Library
- Science
- Maths
- Modern Languages
- ICT suite



Every floor has ICT suites that teachers can take their classes to, in order to do tasks such as online research



Every non-practical classroom has a teaching wall.

The teaching wall has an interactive whiteboard, whiteboards that can be pulled across to write on and storage for equipment needed in class.



On **Third Floor**  
we have:

- Art and Design
- English
- Social Subjects





The corridors are nice and wide.

You always walk on the left whichever direction you are going in.

This means you will not walk into people who are going in the opposite direction to you.



The PE department is in Clickimin.

They have three teaching spaces: Games Hall, 60/40 and a teaching classroom.



School buses drop you off and pick you up at the bus stances at the front of the school.

If you cycle to school there are cycle racks at the front of the school



*How many parts of the school do  
you think you could recognise now?*

*Why not test yourself by completing  
the activity sheet, "Where Am I?"  
on the AHS Website-P7 Transition*