



A Quick Guide to: Procreate



Starting a Project

To start a new project:

1. Click the + button in the top right corner
2. Choose from the different size options or
3. Click the + within the menu to create a bespoke sized canvas.

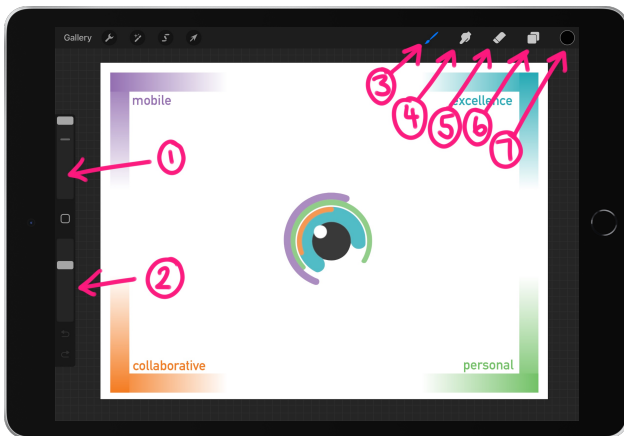
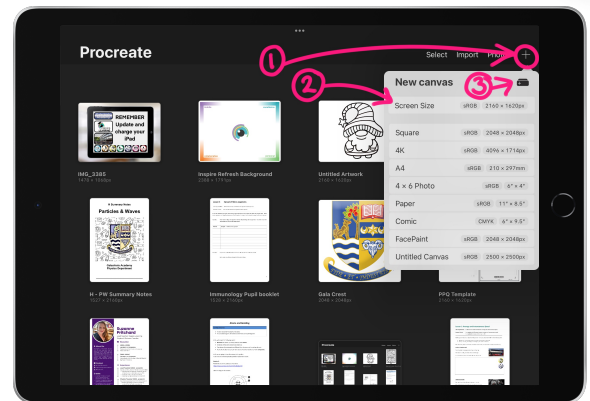

Basic tools

1. Brush size
2. Brush opacity
3. Brush select
4. Smudge
5. Eraser
6. Layers
7. Colour select

Import to a Project

You can import photos, files and documents to a Procreate project:

1. Click the spanner icon in the top left then "+ Add" button
2. Choose the type of file you want to add and select it on your device or
3. Copy and paste element (or the canvas) from within the Procreate project.

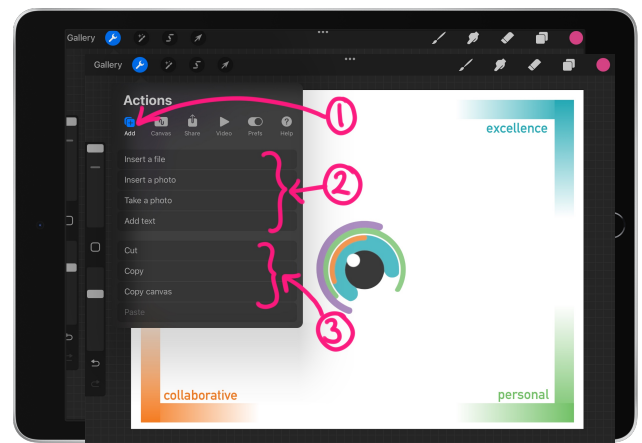



Procreate Layers

1. Open layers by clicking the layer icon in the top toolbar
2. Tap a layer to make it your working layer, it will highlight in blue
3. Click the tap to turn the layer on or off
4. Click unbutton to change the options for that layer
5. Long press on the layer for more options

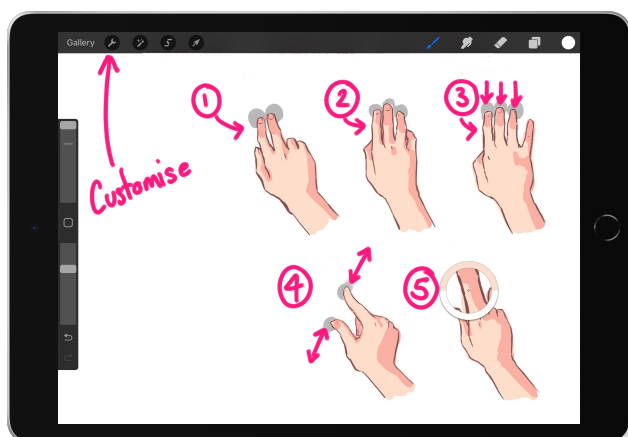
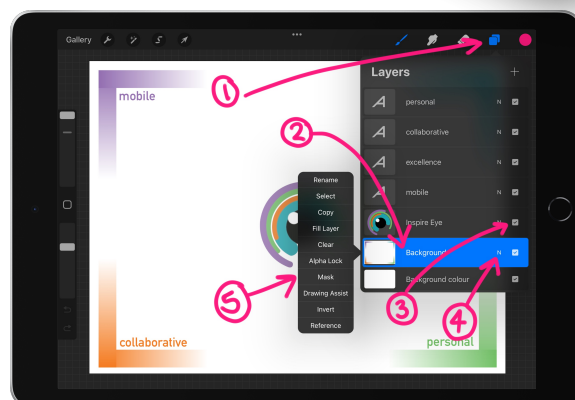

Procreate gestures

Use gestures to quickly perform actions, customise these in the settings menu:

1. Undo
2. Redo
3. Bring up the menu
4. Resize
5. Eye-dropper (to select colour)

Export a Project

You can import photos, files and documents to a Procreate project:

1. Click the spanner icon in the top left then “+ Add” button
2. Choose the type of file you want to add and select it on your device or
3. Copy and paste element (or the canvas) from within the Procreate project.

