

NB: Do not scale from this drawing.

Rev:	Date:	By:	Text:
A	9.1.19	arb	Room areas added. Cupboards incorporated into stage space. Gym store access amended.
B	15.1.19	arb	External store removed. Male & female changing layout altered. WC's revised & accessed from hallway. Existing male change altered to larger store & medical room with WC. External exit from new hall reduced from 2 to 1.
C	16.1.19	arb	External store added. Male & female changing layout altered. WC's revised & accessed from hallway. Medical Room, WC and Store layout amended. Entrance to hall revised & canopy added.
D	18.1.19	arb	Cupbrd.'s removed from store & medical rm. Worktop with sink and under counter unit / fridge added.
E	28.1.19	arb	Fully accessible layout proposed.

Issue Purpose:

**DRAFT**

**south AYRSHIRE COUNCIL**  
**PROFESSIONAL DESIGN SERVICES**  
 Newton House  
 30 Green Street Lane  
 Ayr  
 KA8 8BH  
 Service Lead - Pauline Bradley

Job Title:  
 PROPOSED EXTENSION & REFURBISHMENT  
 DOONFOOT PRIMARY SCHOOL  
 SOUTH AYRSHIRE

Drawing Title:  
 PROPOSED PART FLOOR PLAN

Date of first issue:	Scale:	Drawn by:	Checked by:
NOV '18	1:50	PC	ER
Job Reference:	Drawing Number:	Revision:	
G183230	SK-105	E	

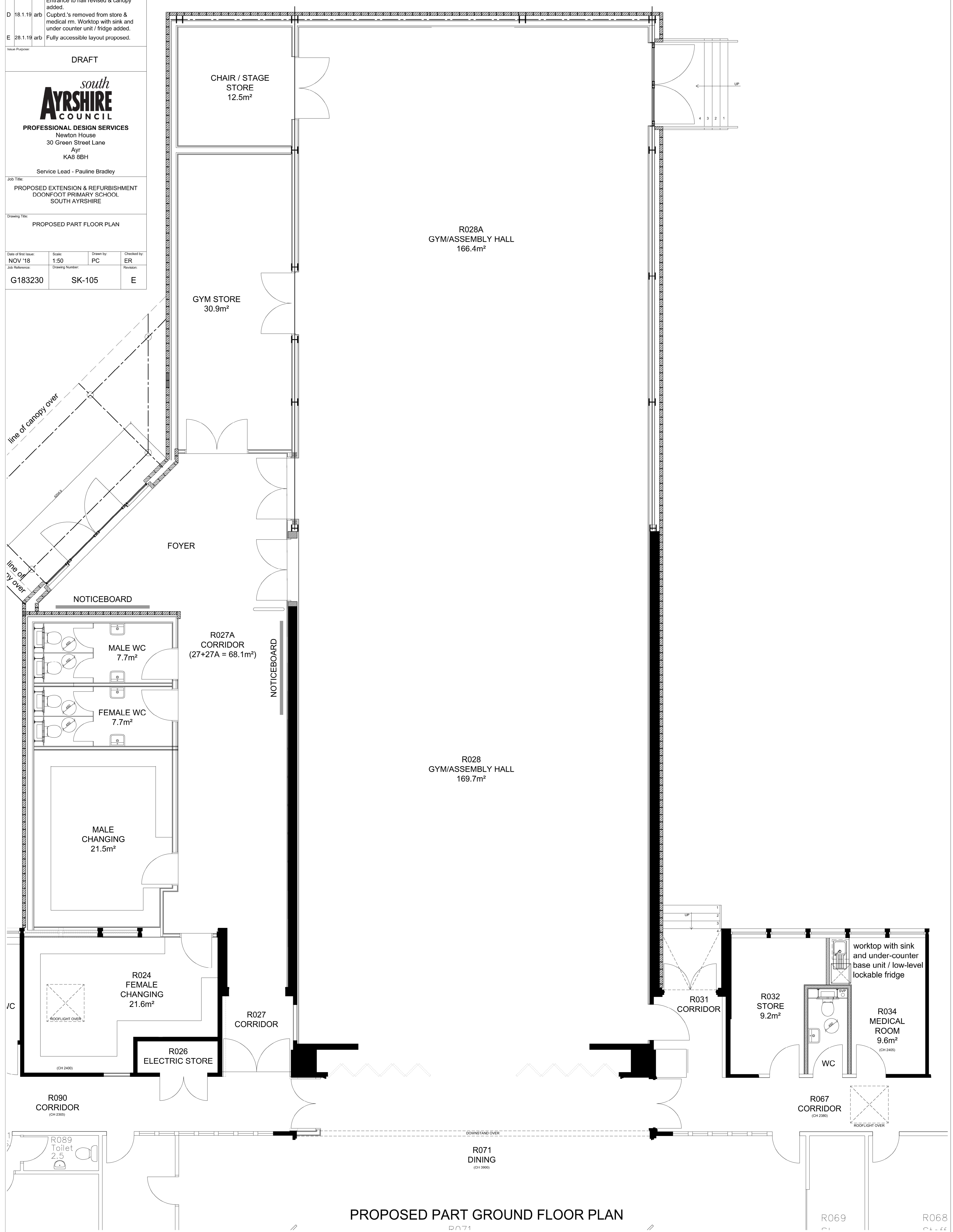

**PROPOSED PART GROUND FLOOR PLAN**