



Bishopton Primary School

Newsletter December 2019



Dear Parent, Carer,

It is hard to believe we are almost at the Christmas break. This has been a very busy term and we are looking forward to the week ahead with a mixture of performances, parties and movie shows. We might even have a visit from a very special person.

On behalf of the staff at Bishopton I would like to take this opportunity to wish you and your family well over the festive period.

Infant Enrolment

Just a reminder that infant enrolment will take place in the school on Wed 15th and Thurs 16th January. Please bring your child's full birth certificate, council tax notification/signed missives and a utility bill/bank statement with you on the day. Child benefit notification is no longer required. All 3 pieces of documentation will need to be produced before the enrolment process is complete. These are required even if you already have a child in the school. If you have any questions please contact the school office.

Pupils should be enrolled in their catchment school and a placing request can be made to any school of choosing. Finally, if you intend to defer your child starting school until the following year, you must still enrol and indicate your intention to defer.

Early Closure

Just a reminder that the school will close at 2.30p.m on Friday 20th December and reopen for staff and pupils at 9.00a.m on Monday 6th January 2020.

Medicines

As the winter takes hold we are seeing an increase in colds and infections. A reminder that if a child requires medication during the school day an adult must complete the 'administration of medicines' form at the school office. All medicines should be handed in to the office. Staff are only permitted to administer prescribed medicines that must be taken during the school day.

Christmas Fair

Congratulations to the BPPC on their very successful Christmas Fair.

It was lovely to see so many people in attendance supporting the school and BPPC.

A huge thank you to the BPPC and all the helpers on the day for their contribution. It is greatly appreciated by all members of our school community. The BPPC raised around £3000 which will greatly benefit all the pupils of the school.

The BPPC is currently fundraising to replace the Promethean boards that they purchased almost 10 years ago and are coming to the end of their natural life.

Football League

The football league has stopped now for the winter break. Bishopton go in to the New Year 1st in group B and through to the local 'Champions League'.

Matches will begin again in February. We thank Mr McAvoy for his hard work in supporting the training and taking the team to the matches.

Green Flag

Our ECO Committee supported by Mrs McAvoy and Mrs Davidson submitted their

application for a Green Flag.
The team worked really hard and we are pleased to announce that we achieved our second Green flag.

Parent Pay

As you know Parent Pay was introduced in October 2019. We are still waiting for a number of parents to activate their accounts and we kindly ask that you do so as soon as possible. If you have misplaced your activation letter please contact the office staff for a replacement.

As well as school lunches this is the system that will be used for school trips, both to pay and to give permission.

It was our understanding that when a trip was set up parents would receive an email alert. However it seems that in order to receive these alerts parents must set this up within the system.

The following screenshots should take you through the process.

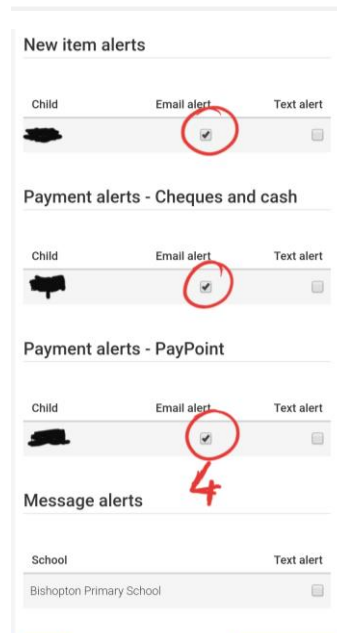
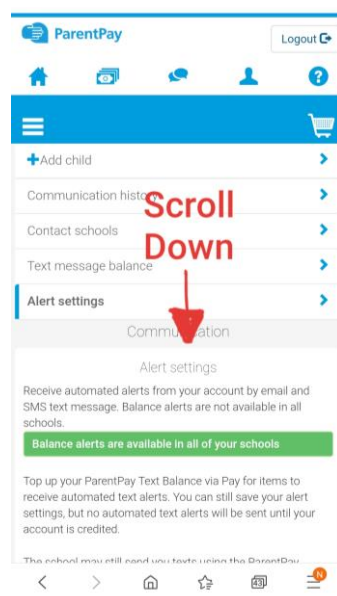
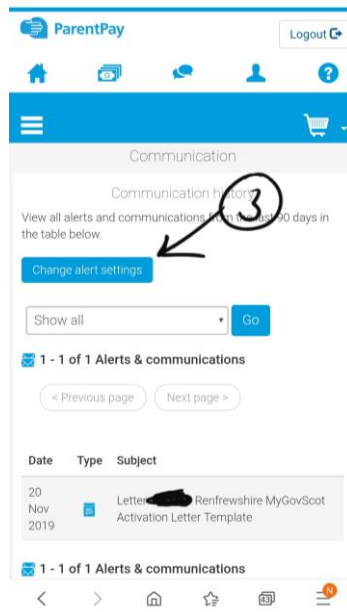
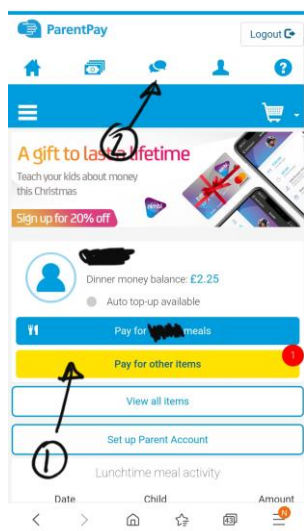

Please note that we will not be using the text alert service as there is a charge for this.

Parking

The police and council have been contacted by a number of residents concerned over the parking issues at the start and end of the day. Please be considerate of our neighbours when you are parking. Please also remember the main designated entrance for pupils is the gate on Old Greenock Road. This is for pupil safety. This entrance allows pupils to access all school entrances without coming into contact with any vehicles. This is also the entrance that will be cleared and gritted in snowy or icy conditions. The Grove is a goods entrance only. The car park is for staff and disabled visitors only. Anyone picking up or dropping off pupils should not enter the car park.

Fraser, our community police, has also been in this week to ask me to remind parents that the yellow zig zag lines outside the school are enforceable and no cars should be stopping here during the times displayed on the signage.

Thank you for your support in keeping our pupils safe.

Yours sincerely

Wendy McNaught

Head Teacher