

C1a

The Plan, Elevation and End Elevation of a Rectangular block are given.

Draw full size using point X as the starting position.

i. A Planometric View of the block

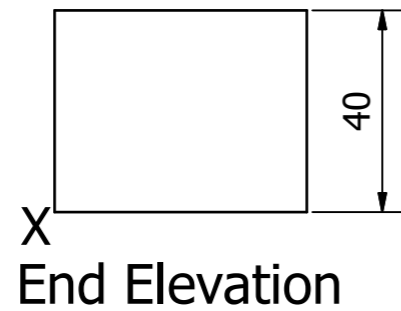
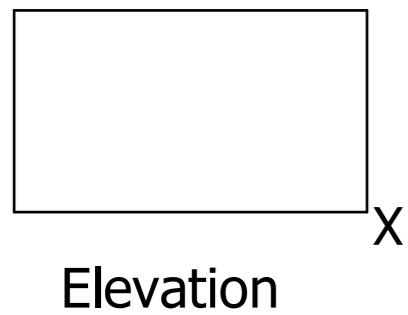
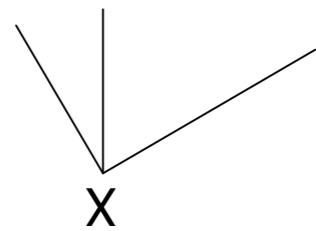
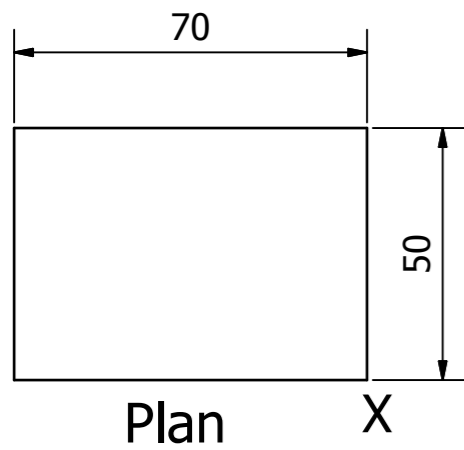

C1b

The Plan, Elevation and End Elevation of a small box are given.

Draw full size using point X as the starting position.

i. A Planometric View of the box

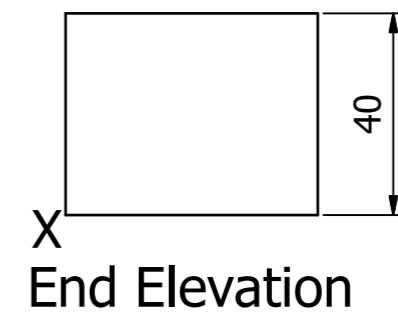
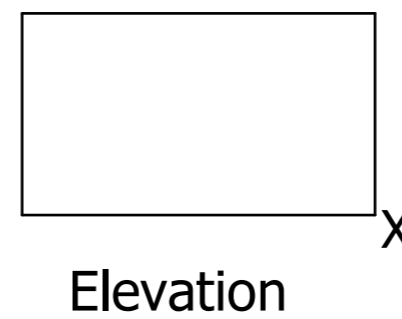
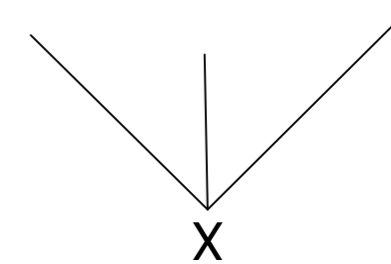
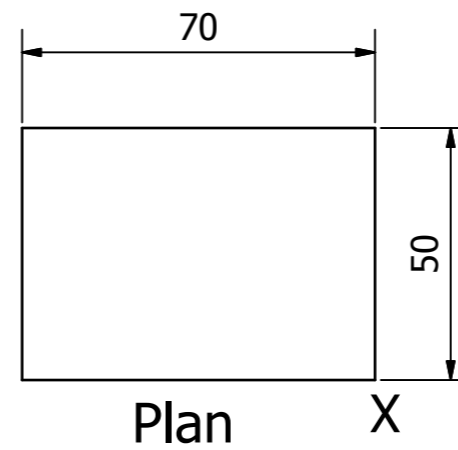

	Good	N to I
Use of construction lines		
Use of outlines		
Correct Dimensions		
Draughtmanship		

Nat4

Nat5

Name

Class

3D Unit Outcome 1

Teacher's Comment

Date Issued

Date Completed

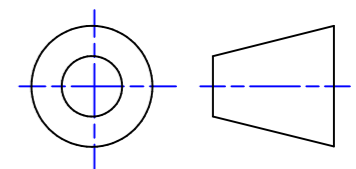

C2

The Plan and Elevation of a locker room are given. An illustration is shown opposite.

Draw full size the planometric of the locker room using point X as the starting position.

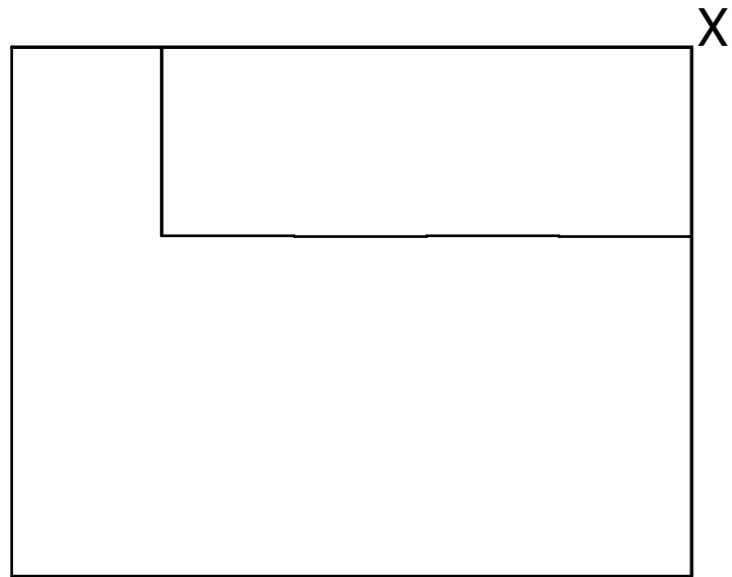

Plan

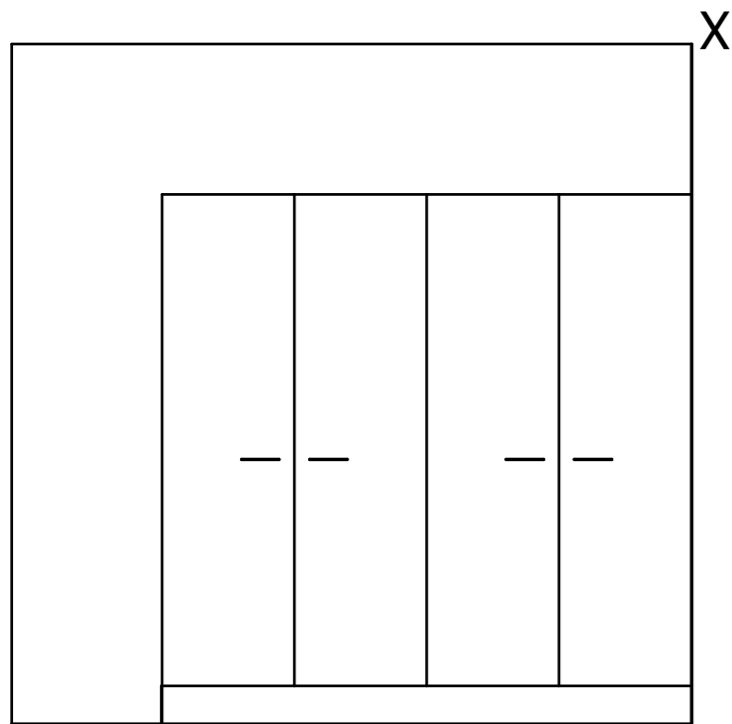

Elevation

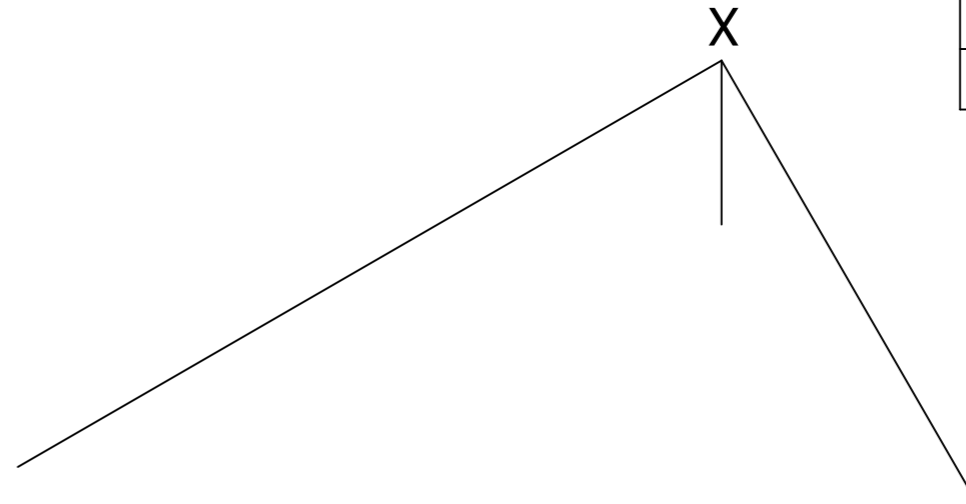

Planometric

	Good	N to I
Use of construction lines		
Use of outlines		
Correct Dimensions		
Draughtmanship		

Nat4	Nat5	Name	Class		
3D Unit Outcome 1		Teacher's Comment	Date Issued	Date Completed	

C3

The Plan and End of a Couch situated in a room are given.  
An illustration is shown.

Draw full size the planometric of the room using point X as the starting position.

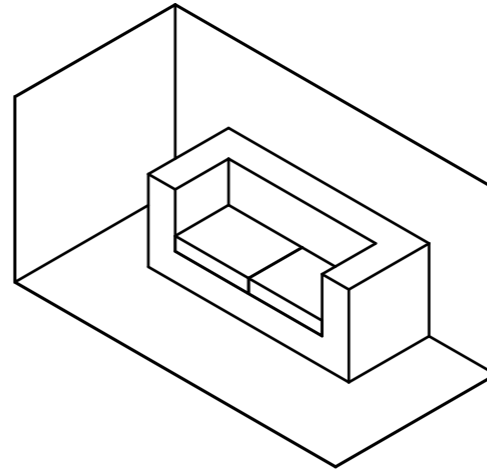

	Good	N to I
Use of construction lines		
Use of outlines		
Correct Dimensions		
Draughtmanship		

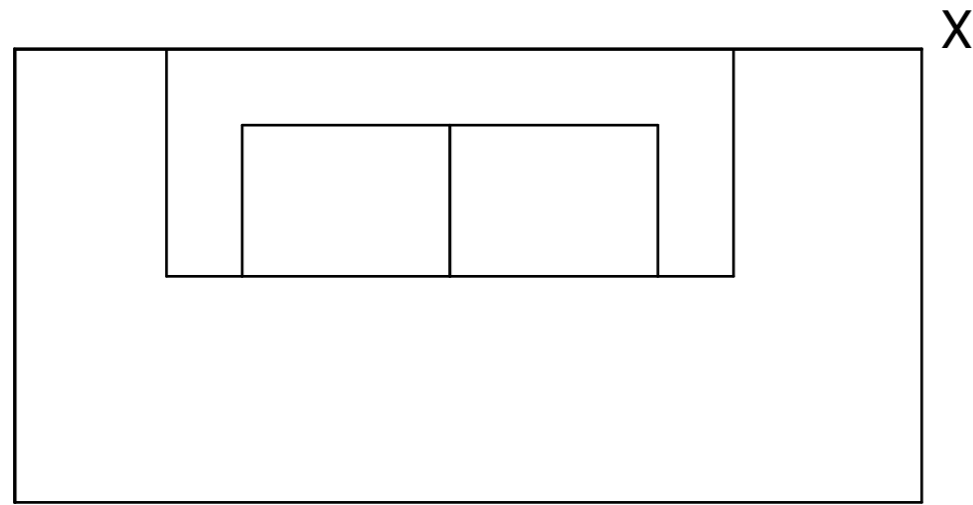

Plan

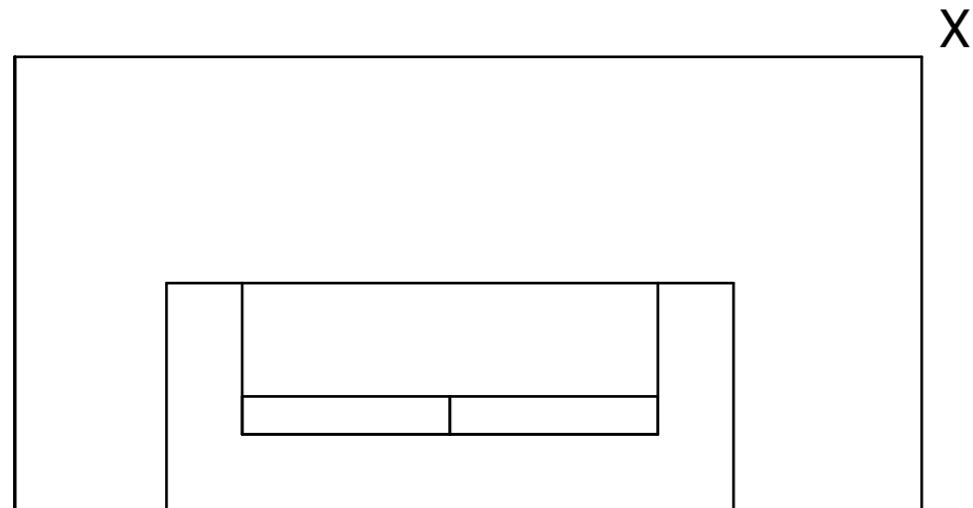

Elevation

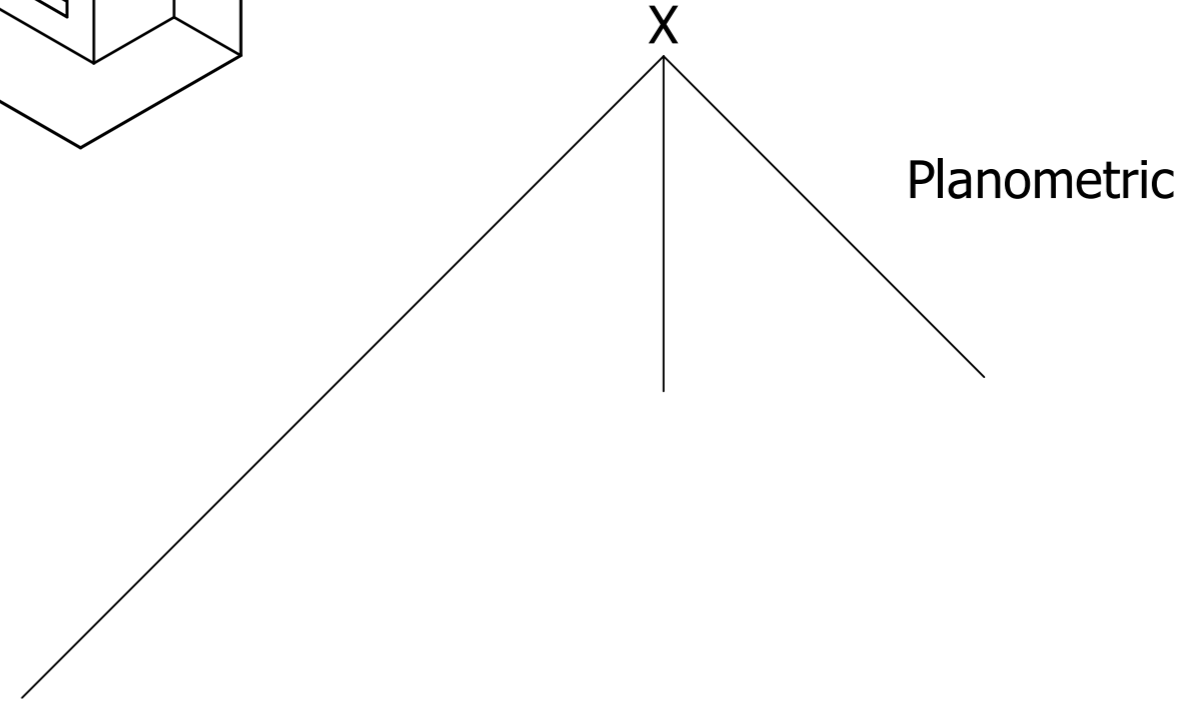

Nat4	Nat5	Name	Class		
3D Unit Outcome 1		Teacher's Comment	Date Issued	Date Completed	

C4

The Plan and Elevation of a desk and filing cabinet situated in an office are given.

Draw full size the planometric of the office using point X as the starting position.

	Good	N to I
Use of construction lines		
Use of outlines		
Correct Dimensions		
Draughtmanship		

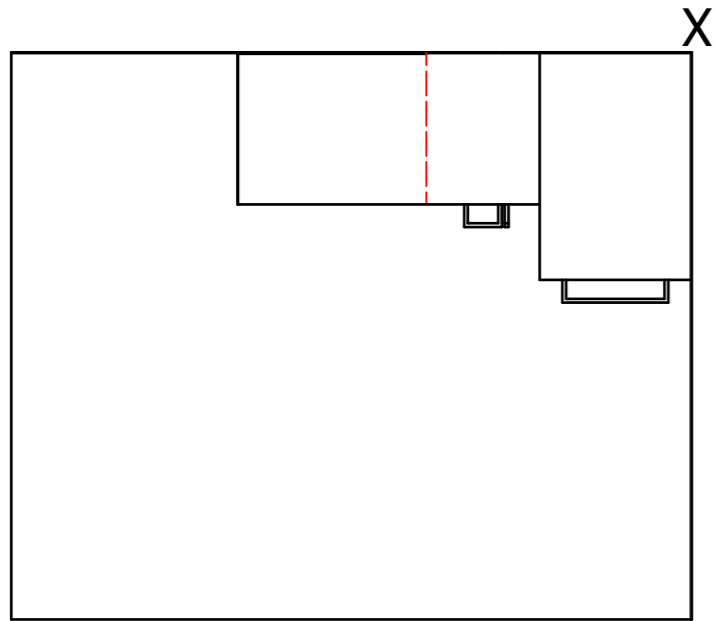

Plan

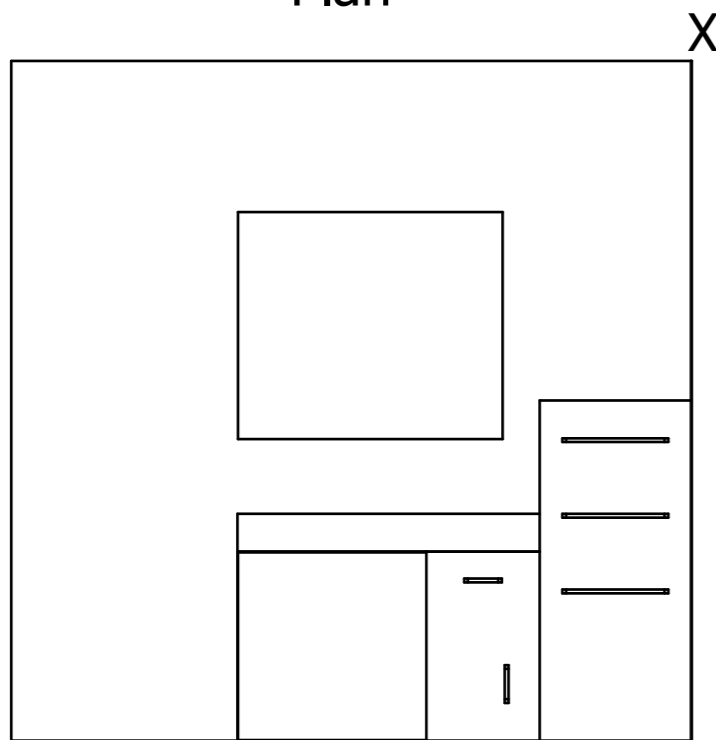

Elevation

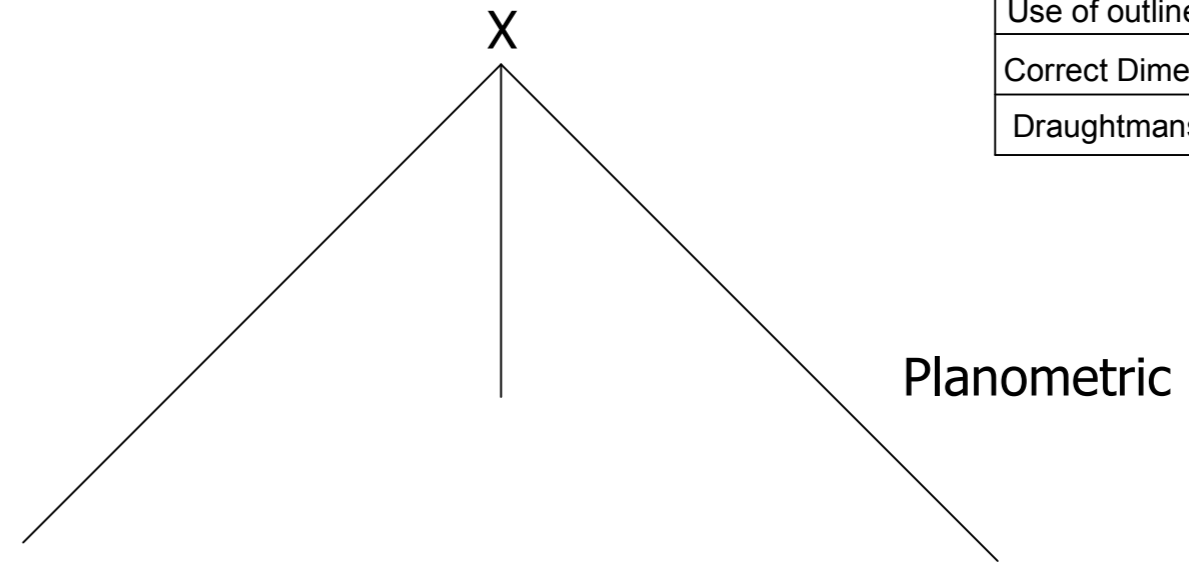

Nat4	Nat5	Name	Class		
3D Unit Outcome 1		Teacher's Comment	Date Issued	Date Completed	

C5

The Plan and Elevation of a sofa, open shelves and rug situated in a room are given. An illustration is shown.

Draw full size the planometric of the room using point X as the starting position.

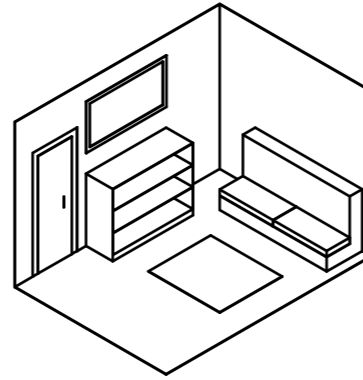

X

	Good	N to I
Use of construction lines		
Use of outlines		
Correct Dimensions		
Draughtmanship		

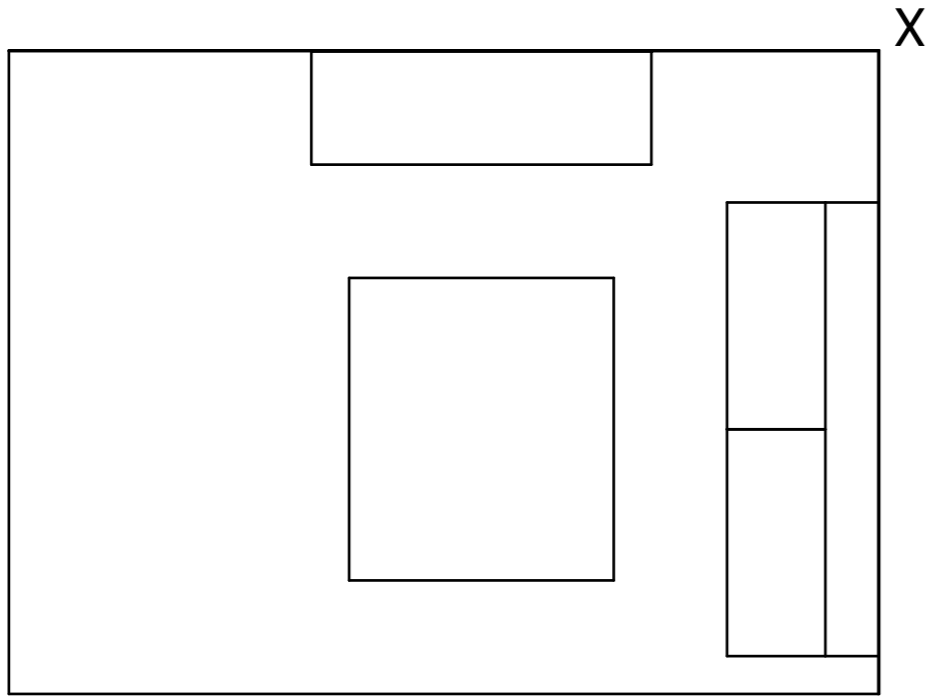

Plan

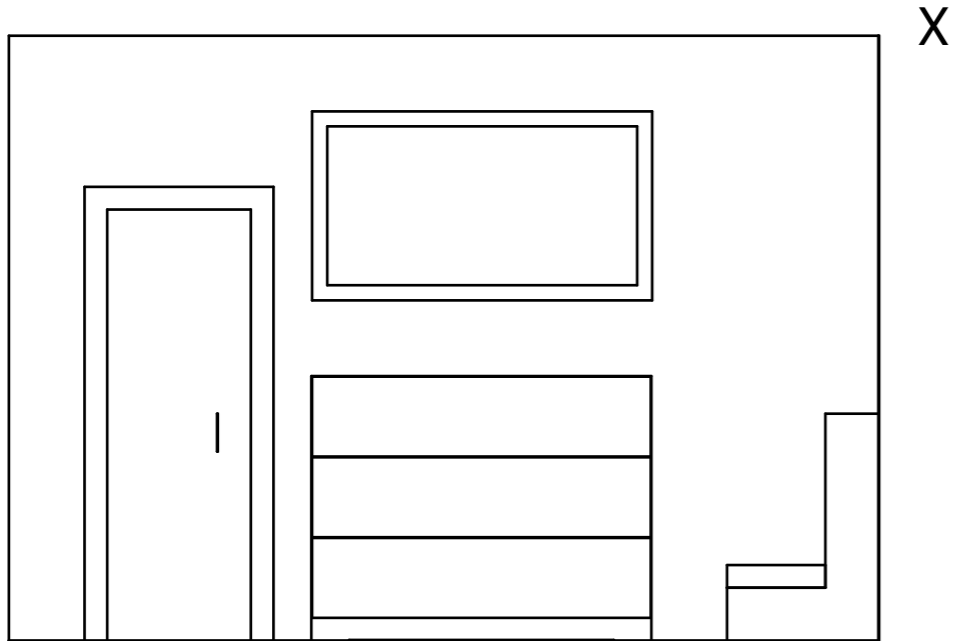

Elevation

Planometric

Nat4	Nat5	Name	Class		
N/A	3D Outcome 1	Teacher's Comment	Date Issued	Date Completed	

C6

The Plan and Elevation of a Kitchen are given. An illustration is shown opposite.

Draw full size the planometric of the Kitchen using point X as the starting position.

	Good	N to I
Use of construction lines		
Use of outlines		
Correct Dimensions		
Draughtmanship		

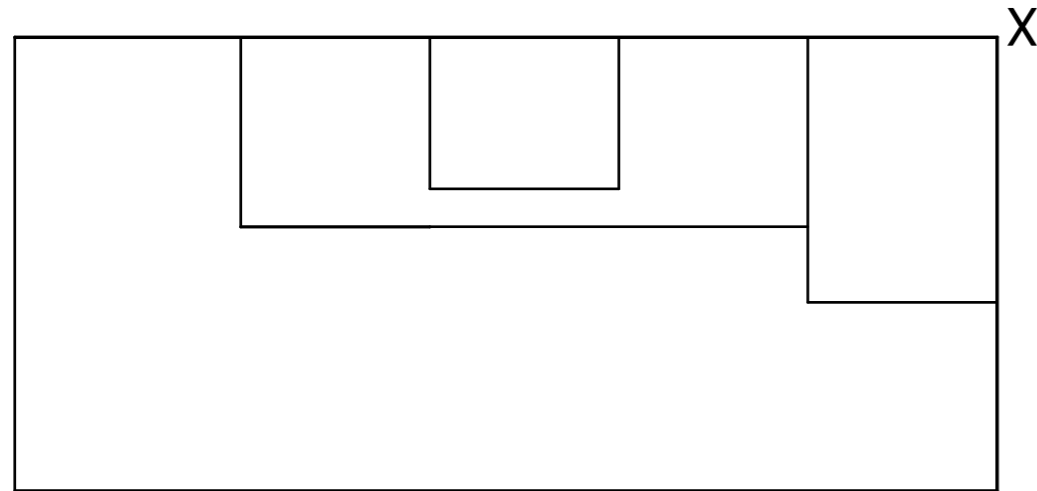

Plan

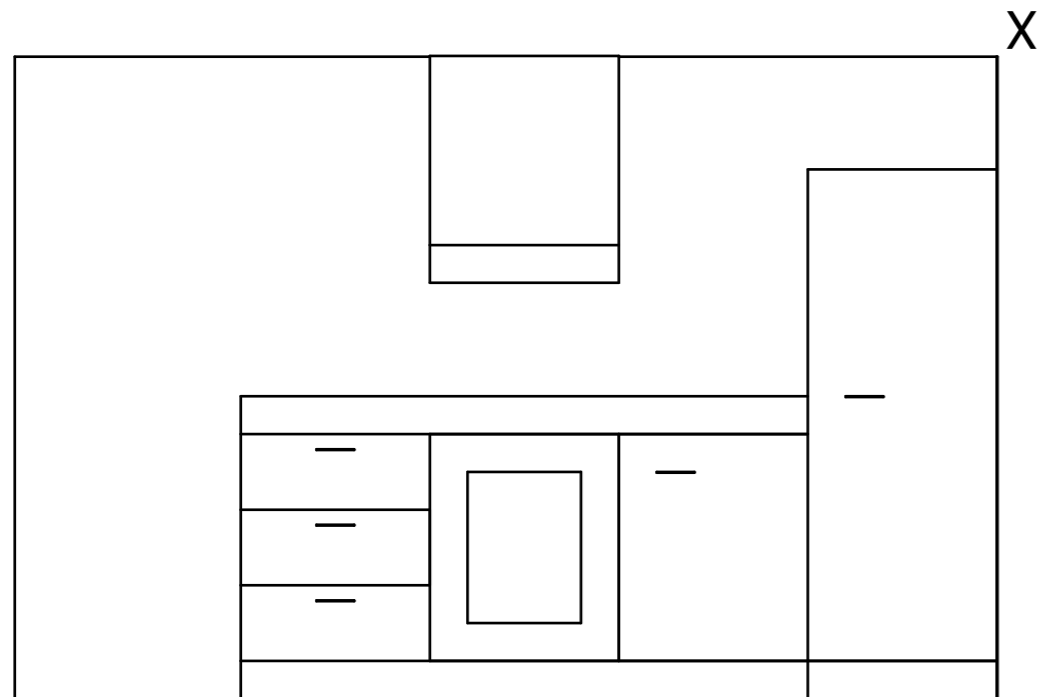

Elevation

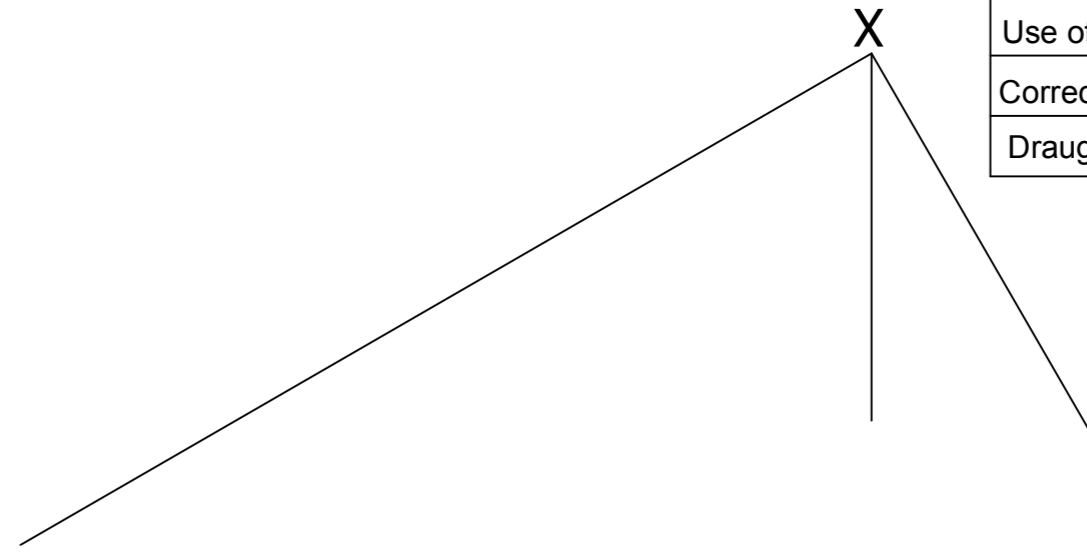

Planometric

Nat4	Nat5	Name	Class		
N/A	3D Outcome 1	Teacher's Comment	Date Issued	Date Completed	