

NORTH AYRSHIRE EDUCATION – STEM HUB CARE AND MAINTENANCE OF SPHEROS

When plugged in, and switched on, the power pack will display a green light.

Best practice dictates that whilst charging, the power pack is left open and charged for 3 hours. If the lid on the power pack is closed during charging, heat will build up and can cause the box to overheat. This results in the power pack 'shutting down' and appearing to be faulty.

The Sphero Edu app allows you to see how much charge a Sphero has. When connected, the Sphero name is displayed and lets you gauge how much battery is left on the device as below. This is shown when the user is attempting to pair a Sphero with their iPad.



Depending on the everyday usage of the devices, there are 2 states the Sphero can be left in after it has been used:

When the Bluetooth device connects to a Sphero the LEDs inside the Sphero are illuminated. When disconnected the LEDs are off but the Robot is not actually off. It is in **SLEEP** mode as it is still discoverable via Bluetooth.

With this there is some residual charge being used by the devices and are therefore still using battery life. If the Spheros are left in this state, when you return the next day, they will have little or no battery life.

Therefore, please turn the Spheros **OFF** after use for storage. To do this – use the Sphero Edu app. When connected to a Sphero, you can tap the Sphero name to view the menu as below. Tap **TURN OFF ROBOT** to turn off the Sphero.

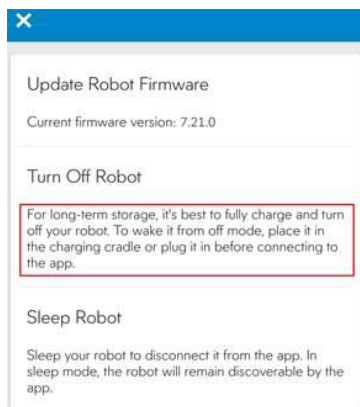

Although the Spheros are waterproof, please ensure they are dry and clean before returning to the power pack as it is not waterproof and any obstruction may prevent the Sphero from charging properly in its cradle.

Further information is available at: <https://support.sphero.com/article/tjh879c1ah-using-the-sprk-power-pack>