

# P7 to S1 Transition Guide

Achievement | Ambition | Respect | Responsibility | Community

## Largs Academy



# Our Vision

- Largs Academy provides all young people with the opportunity to work and learn within a respectful and nurturing environment, where achievement is celebrated in class, in school, and within the wider community
- We endeavour to change lives and transform the school through inspiring, supporting and challenging young people to take responsibility for their learning, to recognise opportunities and fulfil their ambitions

# Our Values

- Respect, achievement, community and ambition are the core values we aspire to live by, and aim to demonstrate, in all aspects of school life, on a daily basis



# Largs Academy House System

- Pupils are organised into house groups - Arran, Bute, Cowal, Kintyre and Mull
- Pupils from the same family are typically in the same house group
- Each house group have their own colour, badge, flag and notice board
- House groups are led by Pastoral Support Teachers

# Pastoral Support

- Pastoral Support Teachers follow the progress of each pupil, in their house group, from S1 until he or she leaves school
- They are concerned with each student's personal, curricular and vocational welfare
- To speak with your child's Pastoral Support Teacher telephone 01475 687687 and make an appointment

# Pupil Support

- The Faculty of Pupil Support provides an array of additional supports for pupils.
- We gather and share primary school transition information with subject teachers to help with learning and teaching. Furthermore, we give guidance and support to subject teachers. In addition, we deliver support in class, in small groups or as a whole class.
- Should you have any concerns regarding your child's progress in their learning telephone 01475 687687 and ask to speak to the head of The Faculty of Pupil Support

# Senior Leadership Team



**Mr Doherty**

Head Teacher



**Mrs McClelland**

Depute Head Teacher

Year Head for S1 & S4



**Mr Wilson**

Depute Head Teacher

Year Head for S2 & S5



**Mr Frew**

Depute Head Teacher

Year Head for S3 & S6

# Pastoral Support



**Mr McCoy**

Arran House



**Miss Furey**

Bute House



**Mr Gibson**

Cowal House



**Mr Sinclair**

Kintyre House



**Miss McIlroy**

Mull House

# Pupil Support Teachers



**Mr Elliott**

Arran House



**Mrs Henderson**

Bute House



**Mr McLean**

Cowal House



**Mr Halbert**

Kintyre House



**Mrs Blair**

Mull House



**Mrs McTaggart**

Faculty Leader

# Show My Homework (SMHW)

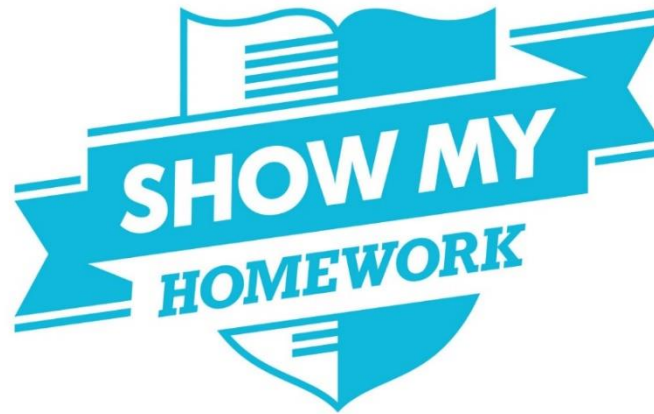

- Show My Homework is a simple online homework calendar showing homework information, deadlines and attachments for students.
- All students' homework will be displayed online using Show My Homework.
- Pastoral Support will provide information and guidance to both pupils and parents / carers on SMHW.



# Timetable

- 32 period week
- Mondays and Tuesdays 9:00am - 3:55pm
- Wednesdays, Thursdays and Fridays 9:00am - 3:05pm
- 50 minute periods
- Morning registration every morning 9:00am – 9:10am

### Largs Academy Timetable

	REG 09:00-09:10	PERIOD 1 09:10-10:00	PERIOD 2 10:00-10:50	INTERVAL 10:50-11:05	PERIOD 3 11:05-11:55	PERIOD 4 11:55-12:45	PERIOD 5 12:45-13:35	LUNCH 13:35-14:15	PERIOD 6 14:15-15:05	PERIOD 7 15:05-15:55
<b>MON</b>	Registration			Interval				Lunch		
<b>TUE</b>	Registration			Interval				Lunch		
	REG 09:00-09:10	PERIOD 1 09:10-10:00	PERIOD 2 10:00-10:50	INTERVAL 10:50-11:05	PERIOD 3 11:05-11:55	PERIOD 4 11:55-12:45	LUNCH 12:45-13:25	PERIOD 5 13:25-14:15	PERIOD 6 14:15-15:05	
<b>WED</b>	Registration			Interval			Lunch			
<b>THU</b>	Registration			Interval			Lunch			
<b>FRI</b>	Registration			Interval			Lunch			

# Lunchtime

- Pupils use their Young Scot Card to pay for their school meals. The card will be issued to pupils before the start of S1.
- Parent Pay allows parents and carers to:
  - pay for school meals online
  - see what meals your child has been buying
  - check your child's balance
  - top up at your convenience
- Click on the following web link: [www.parentpay.com](http://www.parentpay.com)
- If online payment is not a suitable option, North Ayrshire Council can issue a PayPoint card - to request a PayPoint card, phone 01294 324759.

# Get to know Largs Academy



Pupils are advised to look out for **signs** to help them navigate around the school

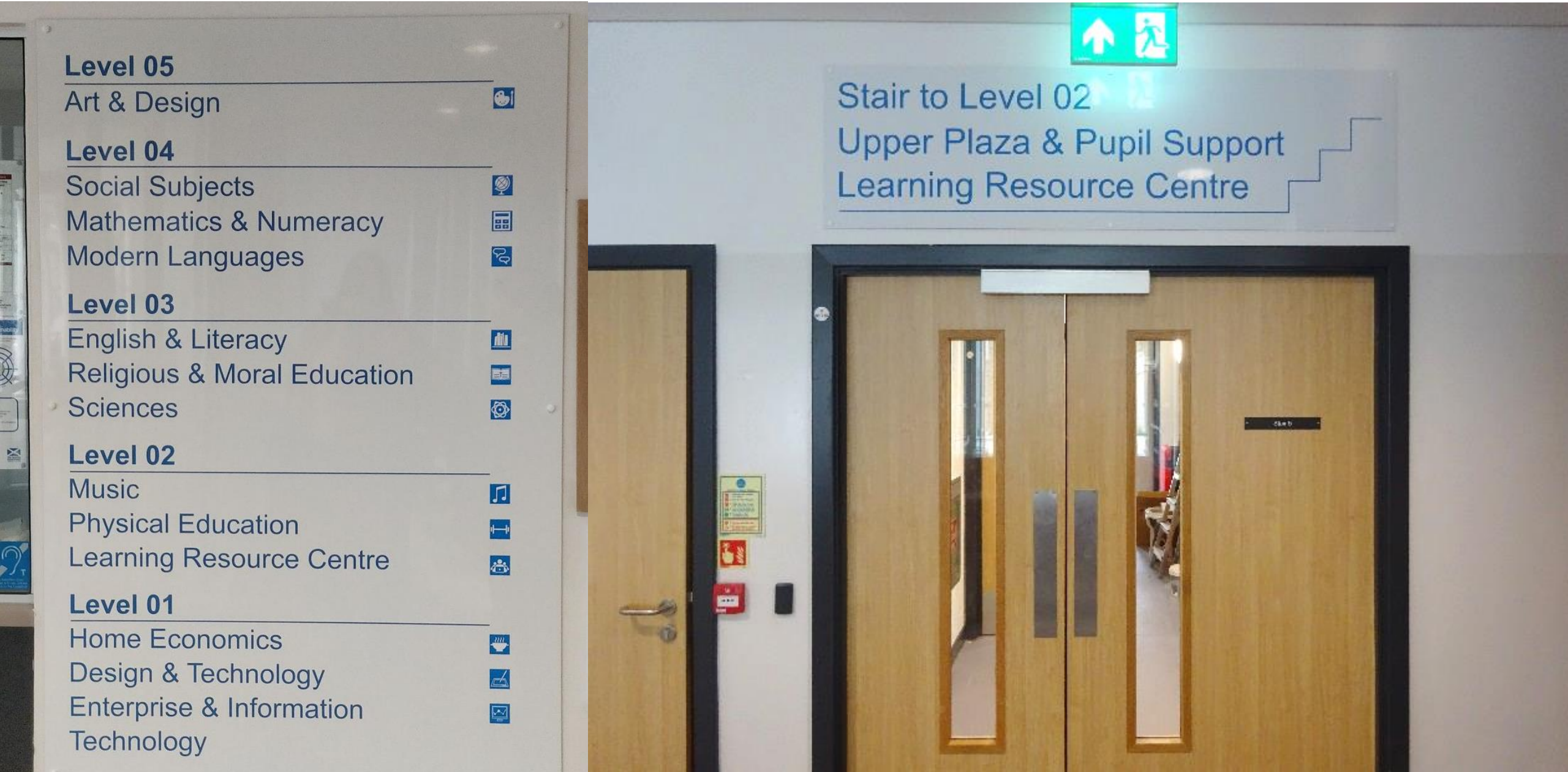

**Level 05**

Art & Design



**Level 04**

Social Subjects



Mathematics & Numeracy



Modern Languages



**Level 03**

English & Literacy



Religious & Moral Education



Sciences



**Level 02**

Music



Physical Education



Learning Resource Centre



**Level 01**

Home Economics



Design & Technology



Enterprise & Information



Technology

Stair to Level 02

Upper Plaza & Pupil Support  
Learning Resource Centre



Pupils will enter via the **Main Entrance**



**Images** and **quotes** on walls can help pupils recognise what department they are in



Pupils have the opportunity to use the **school library**



Pupils can rent a **locker** to store belongings



# Upper Plaza – Food Serving & Seating Area



# Upper Plaza – Pupil Social Areas



# Level 1 - North Block - Home Economics (HE) & Design and Tech (DT)

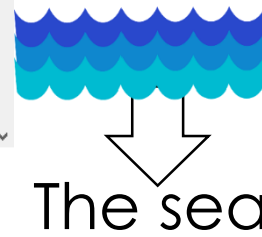

# Level 1 - South Block - Business and Computing (IT)

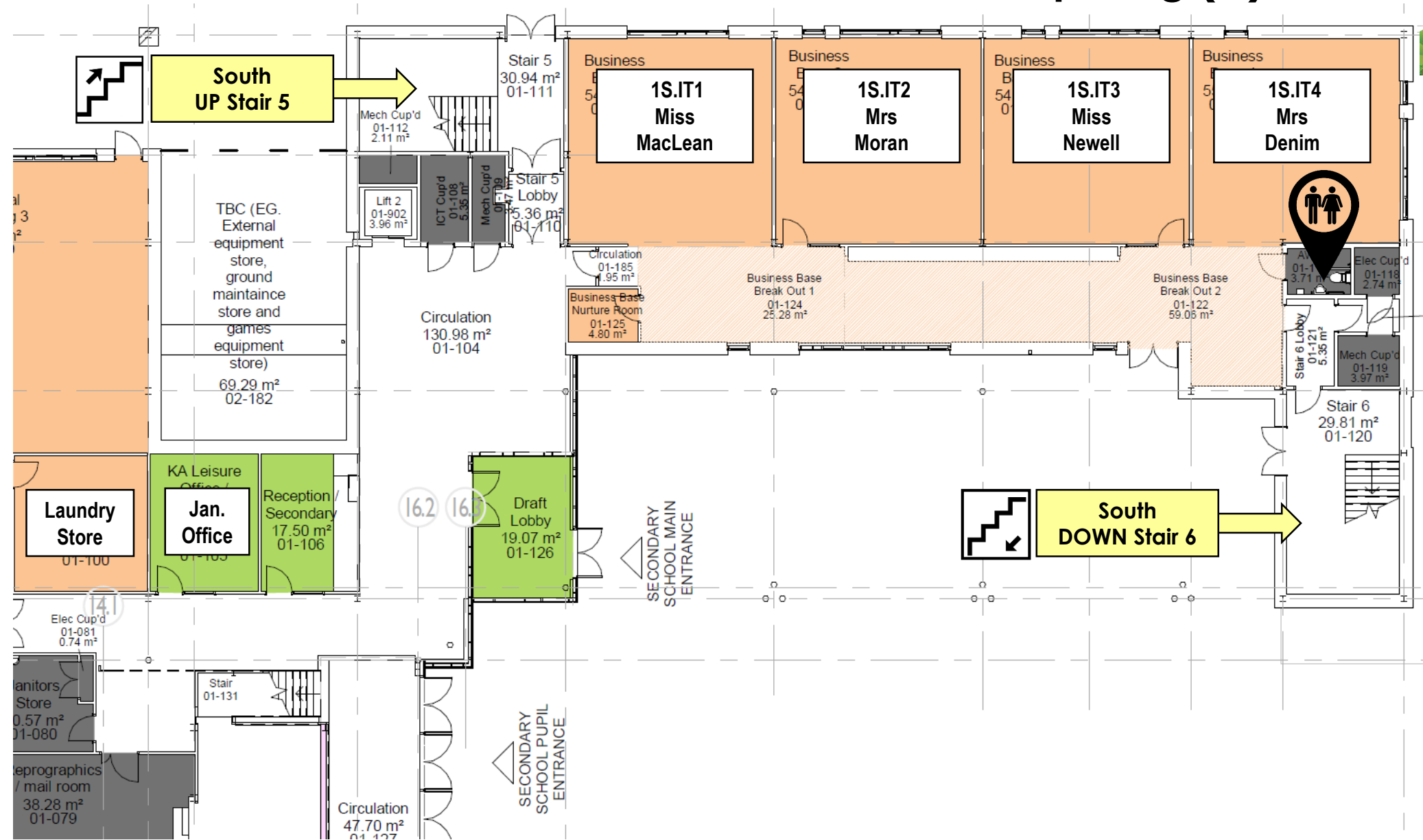
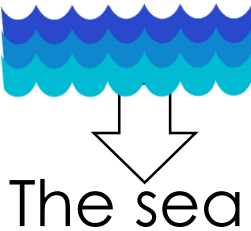

# The hills

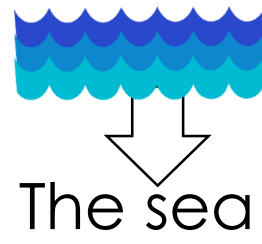

# Level 2 - South Block - Drama, Pupil Support, Pastoral Support, Head Teachers, Learning Resource Centre & General Office

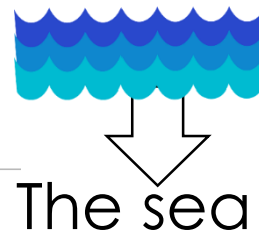
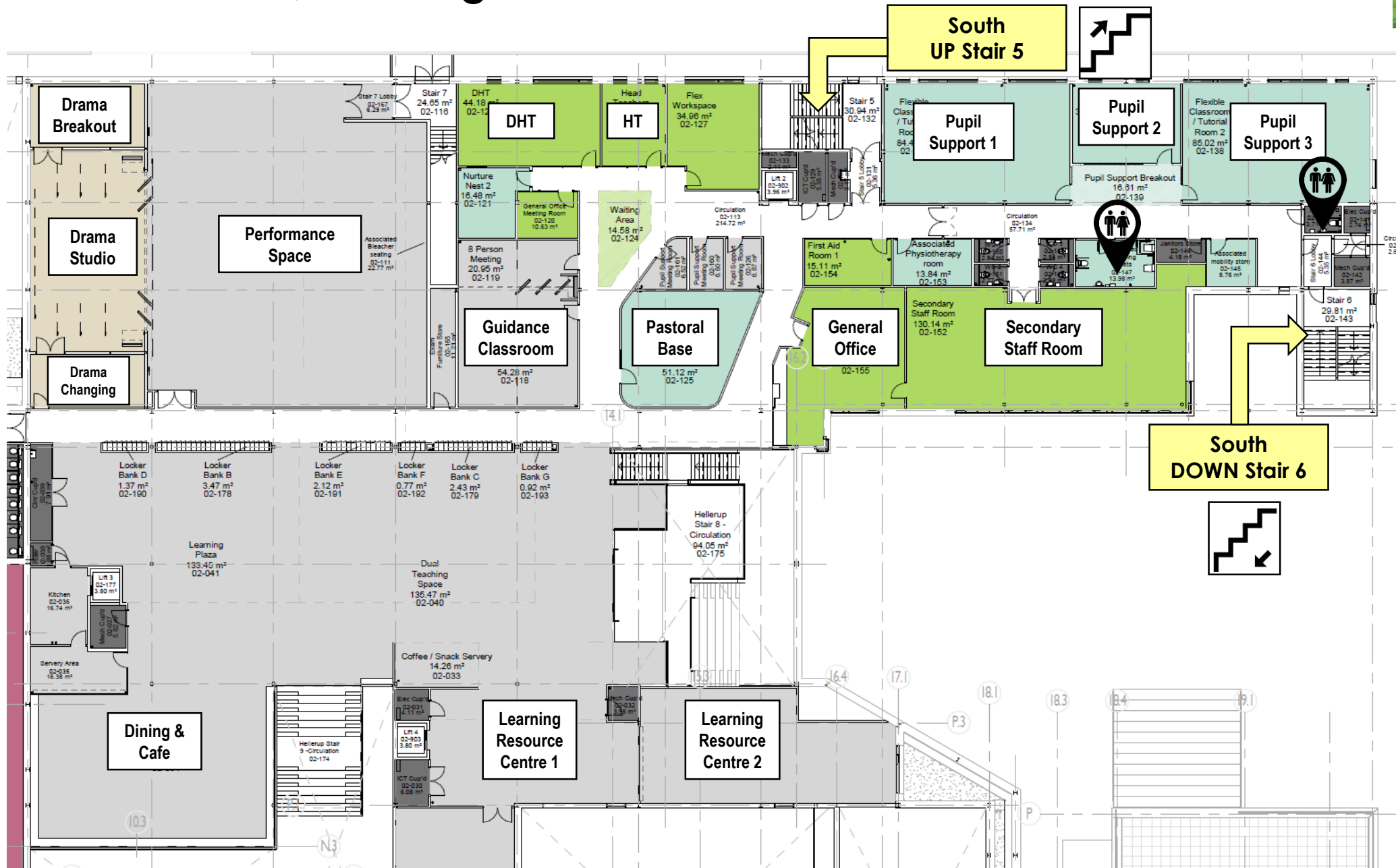

# Level 3 - North Block – English (E)

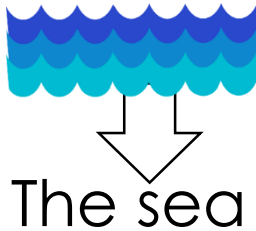
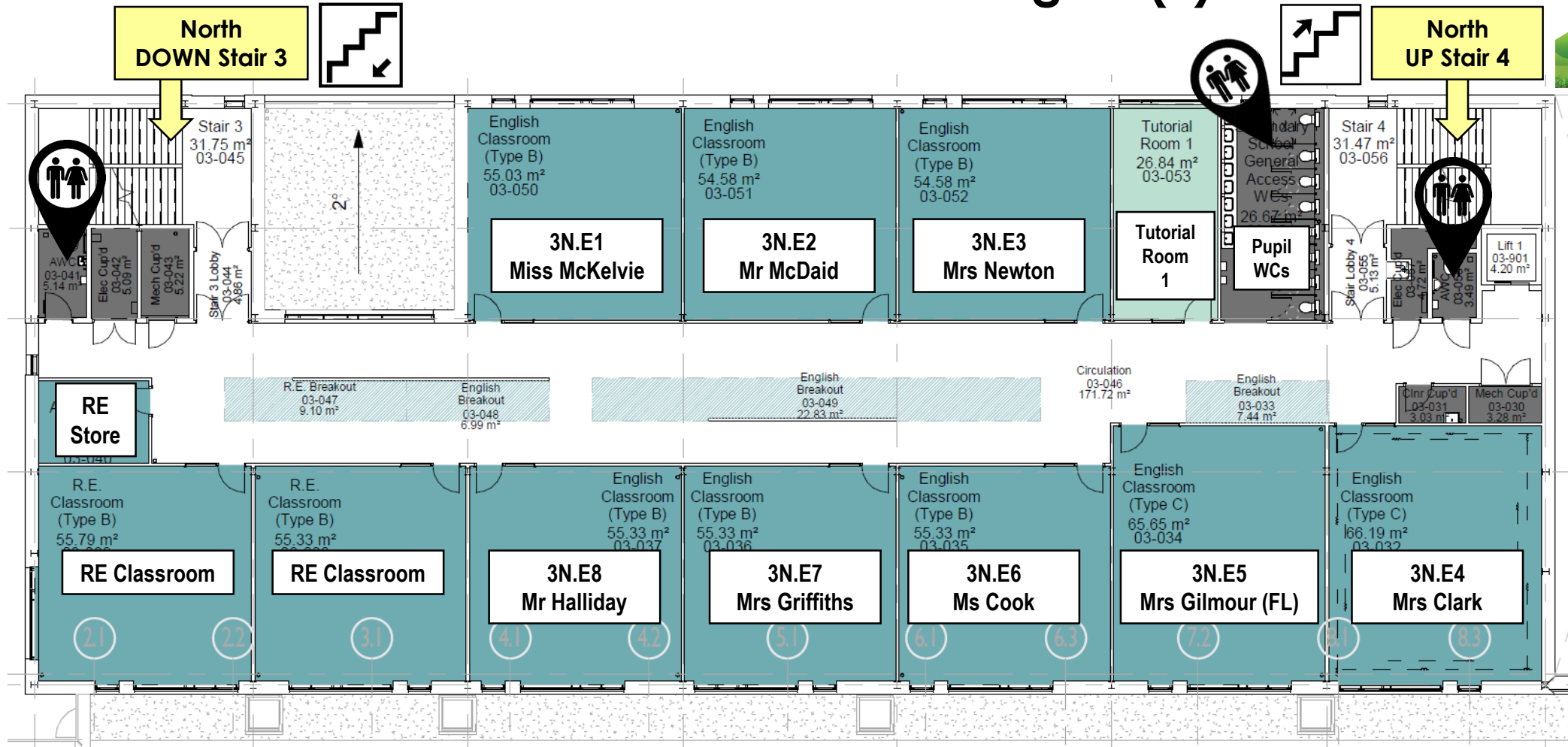

# Level 3 - South Block – Science (Sc)

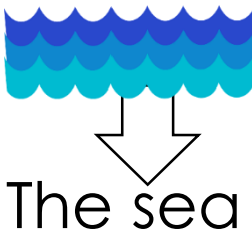
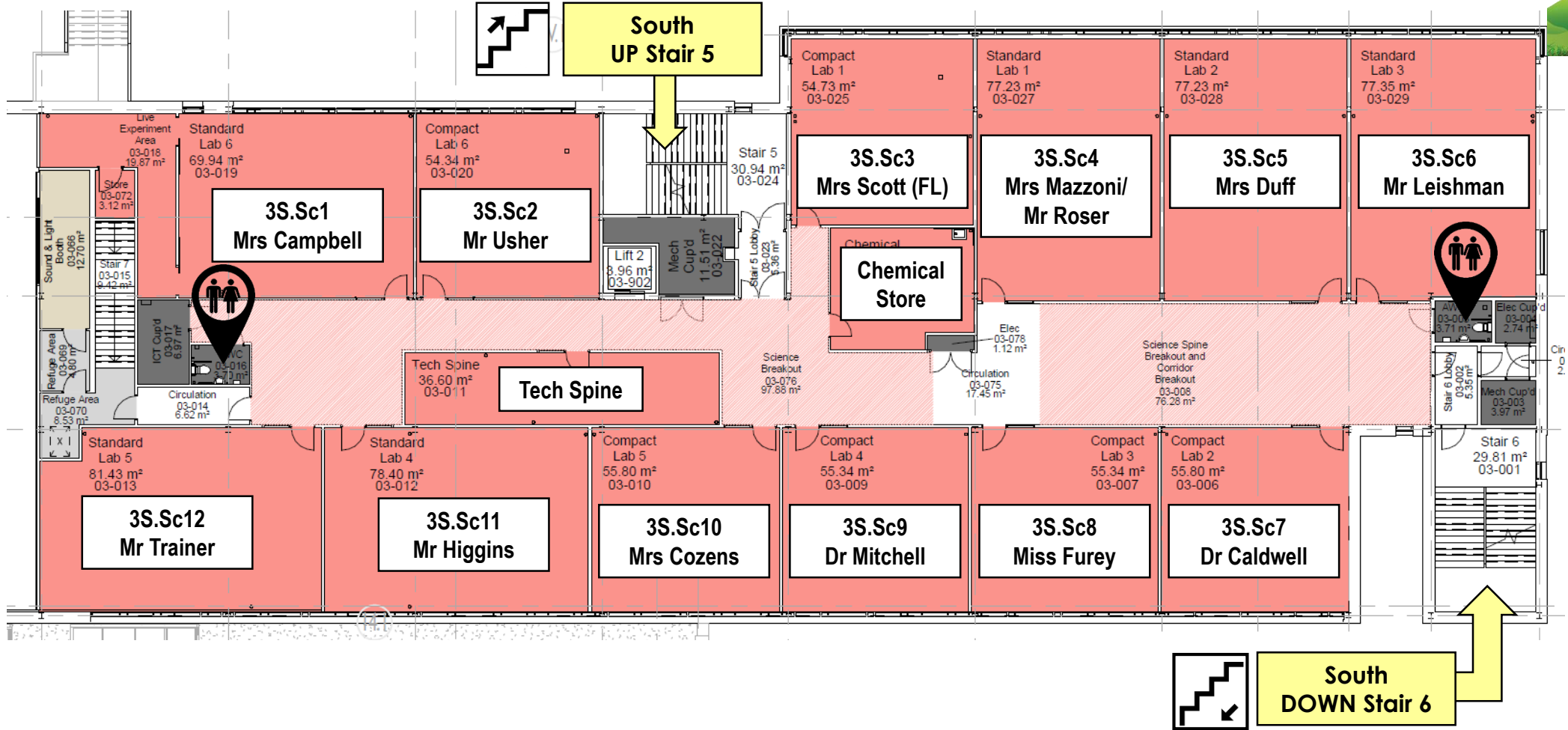

# Level 4 - North Block - Social Subjects (SS), Modern Languages (ML) & Religious and Moral Education (RME)

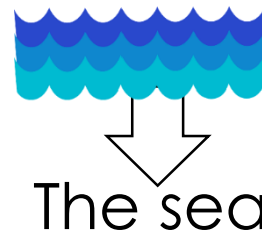
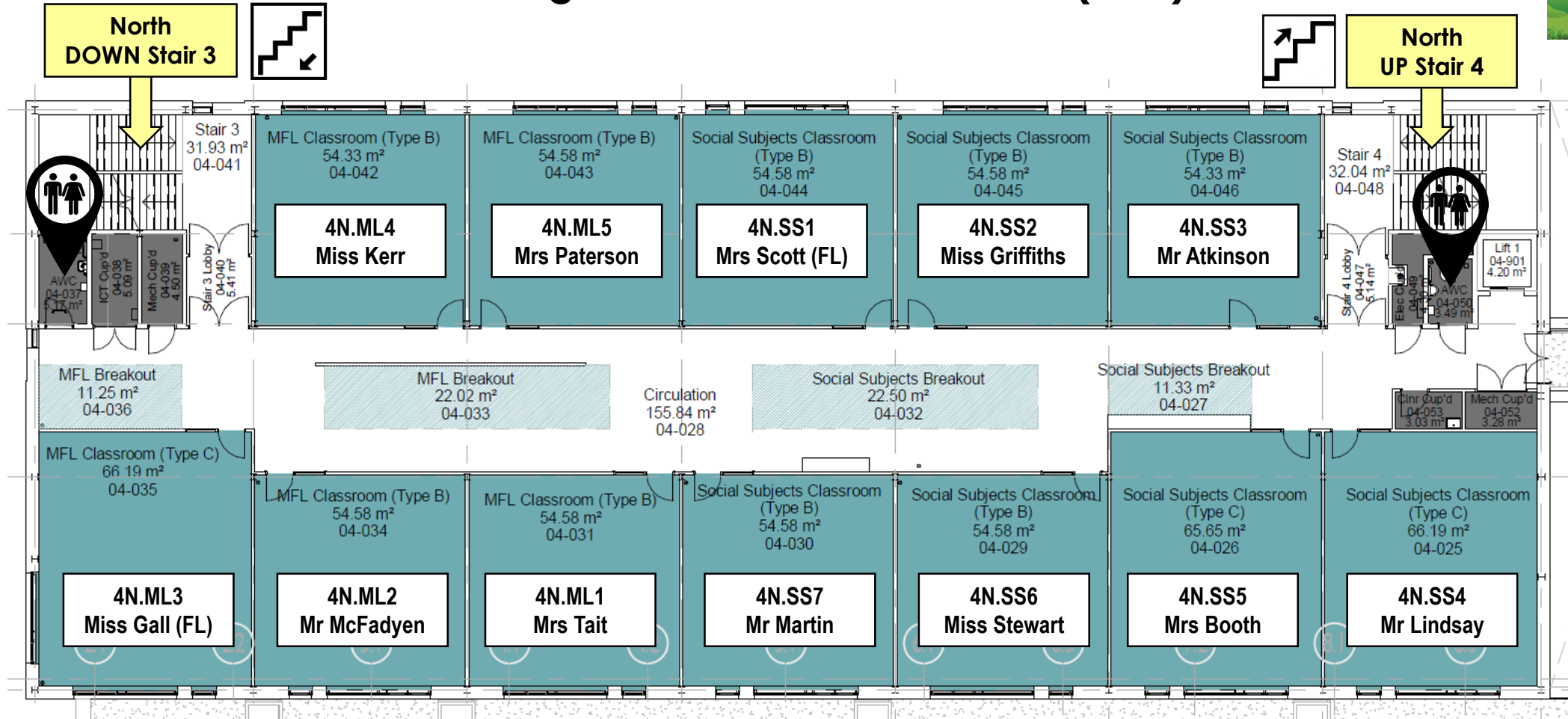

# Level 4 - South Block – Maths (M)

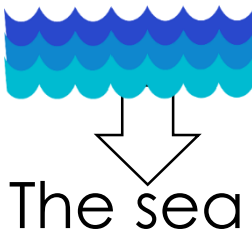
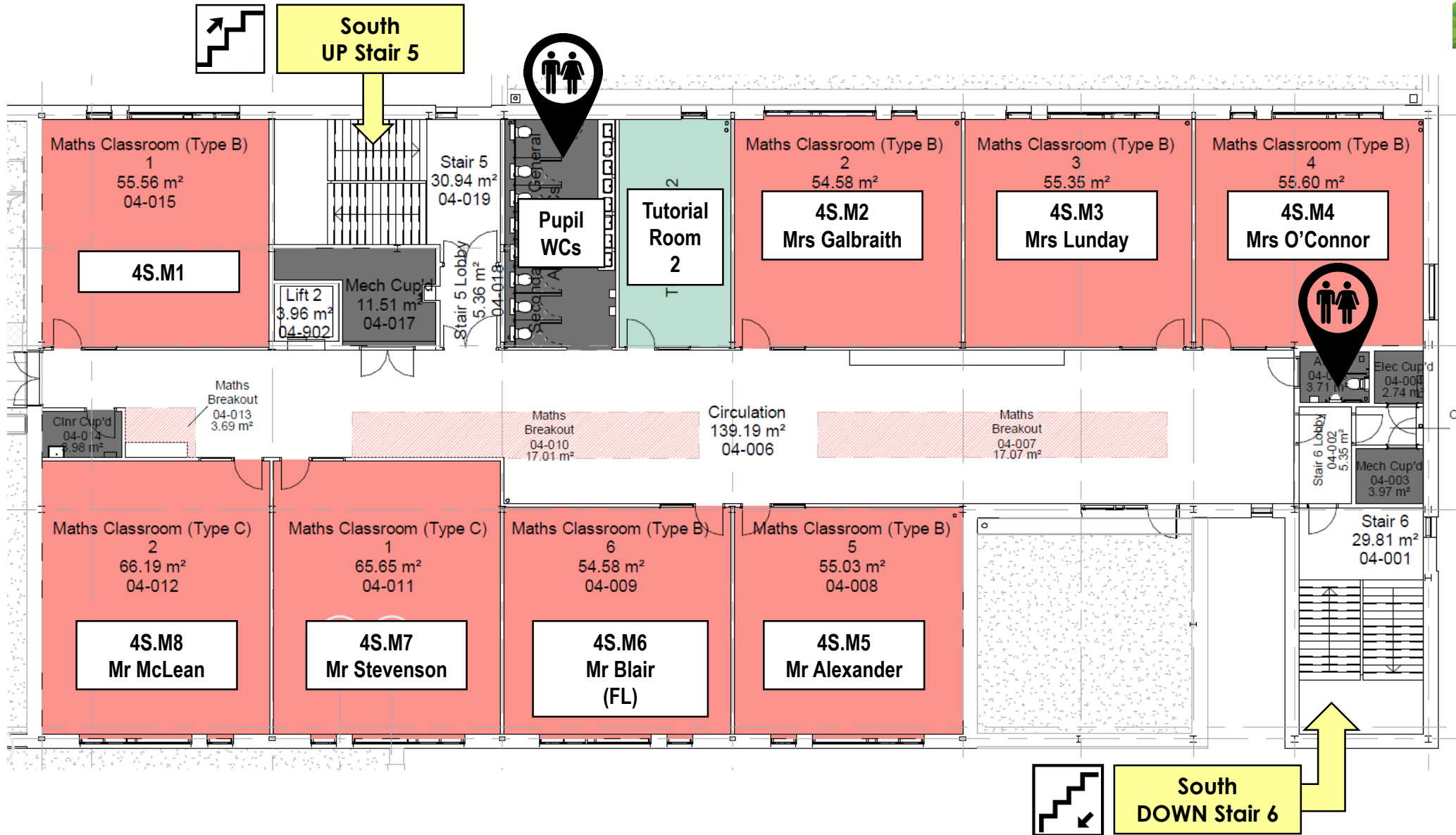

# Level 5 - North Block Art & Design (A)

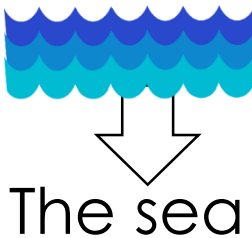
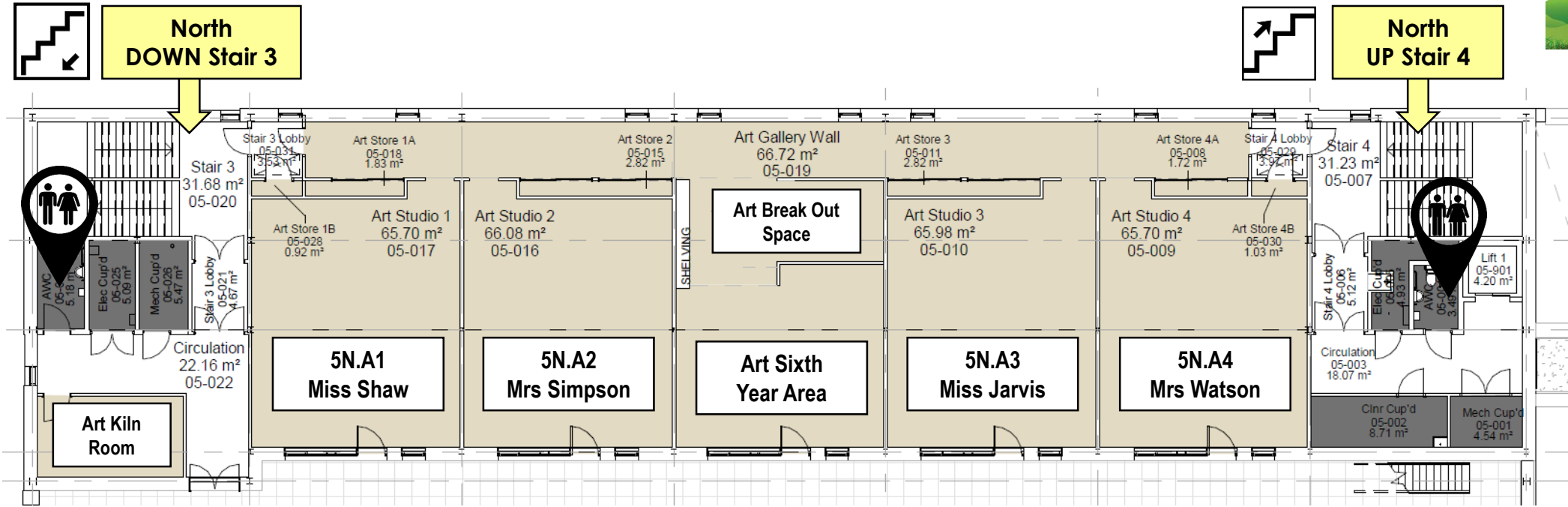

Achievement | Ambition | Respect | Responsibility | Community

# Largs Academy



Follow Us

