

Global Citizenship – An Interdisciplinary Approach in Primary School

@GCEducationScot



Maths & Architecture

Valuing diversity within the field of architecture through a STEM project.

- Learning context:
 - Learning to calculate area and perimeter
 - Design a new landmark for your city, considering its purpose and who it will benefit
 - Include an aspect of sustainability to help the local environment
 - Learn about the contribution of people around the world in the field of architecture, such as Black architect, Arthur Timothy:

<https://www.bbc.co.uk/teach/class-clips-video/pshe-ks1-ks2-proud-to-be-an-architect/zbf/6v4>

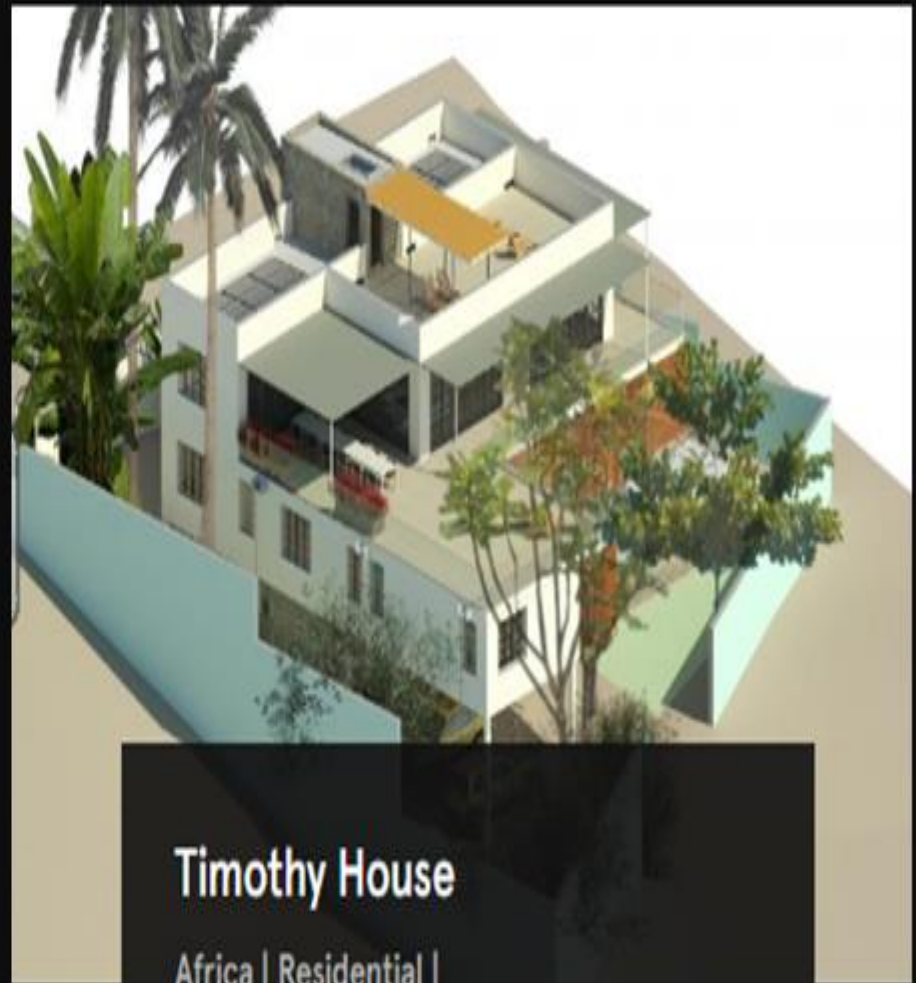

Mathematics

I can explain how different methods can be used to find the perimeter and area of a simple 2D shape or volume of a simple 3D object.

MNU 2-11c

Literacy

I can convey information, describe events, explain processes or combine ideas in different ways.

LIT 2-28a

Health and Wellbeing

I make full use of and value the opportunities I am given to improve and manage my learning and, in turn, I can help to encourage learning and confidence in others.

HWB 2-11a

@GCEducationScot

Expressive Arts

I have the opportunity to choose and explore an extended range of media and technologies to create images and objects, comparing and combining them for specific tasks.

EXA 2-02a

Learning Context

Mathematics: Area & Perimeter

Global Citizenship Focus: Sustainable Cities and Communities

ICT and Technologies

Through discovery and imagination, I can develop and use problem-solving strategies to construct models.

TCH 2-14a

During practical activities and design challenges, I can estimate and measure using appropriate instruments and units.

TCH 2-13a

Social Studies

Having explored my local area, I can present information on different places to live, work and relax and interesting places to visit.

SOC 2-10a

I can discuss issues of the diversity of cultures, values and customs in our society.

SOC 2-16c

Science

By considering examples where energy is conserved, I can identify the energy source, how it is transferred and ways of reducing wasted energy.

SCN 2-04a

Sustainable Development Goals

SDG 11: Sustainable Cities and Communities

Focus for Assessment

SAY: Identify a variety of famous architects around the world & the inspiration behind their ideas.

MAKE: Draw a 2D floor plan of your building.

WRITE: Identify the purpose of your building and its use to Glasgow's citizens. Also write about the element of sustainability your building design incorporates.

DO: Construct a 3D model from a 2D plan of a building designed as a group