

3D Glasses

Information

This task is based around a case for 3D cinema glasses. It is a plastic case which has a pull-off top. A set of graphics is included which will allow you to complete your task.

You have been tasked with:

- ◆ Accurately reproducing the given orthographic views provided, using drawing techniques.
- ◆ Drawing an end elevation.
- ◆ Drawing a sectional elevation of the assembled lid and body.
- ◆ Producing an accurate true shape of the lid top.
- ◆ Drawing a surface development of the main body label.
- ◆ Selecting the lid top true shape or the main body label and producing a meaningful 2D promotional graphic.
- ◆ Calculating the height and diameter of a promotional sales container which will sit in the cinema foyer. It is to be an exact scaled replica of the case and be on a scale of **8:1**.

You will be asked to explain your colour choices and the graphic techniques you have used.

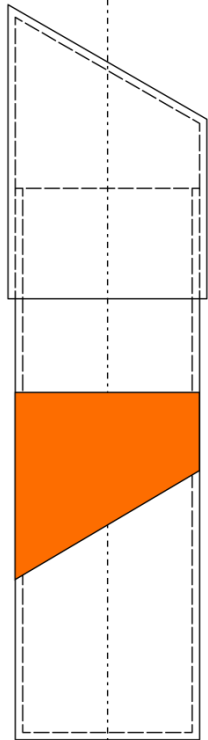
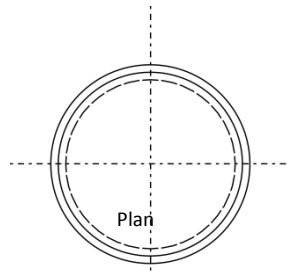

Base sits 35mm inside lid.

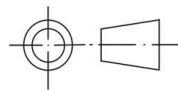

Not to scale.
All dimensions are in millimetres.
Wall thickness is 2mm.

